



HYDR-STAR FLUID CONTROL COMPANY LIMITED



## Control Valves and Components

(For Process, Wellhead and Safety Shutdown Systems)

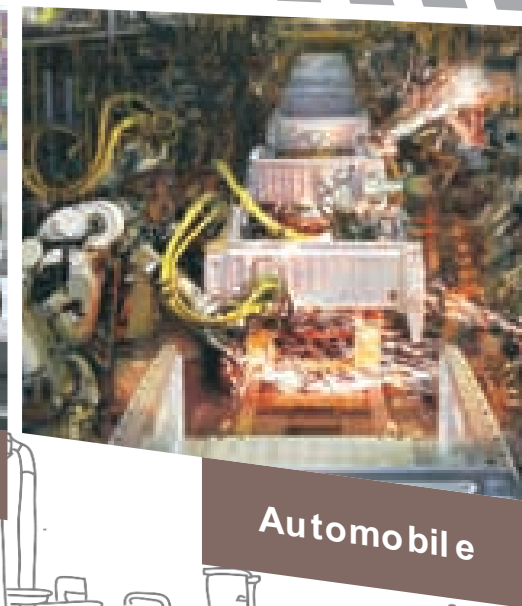
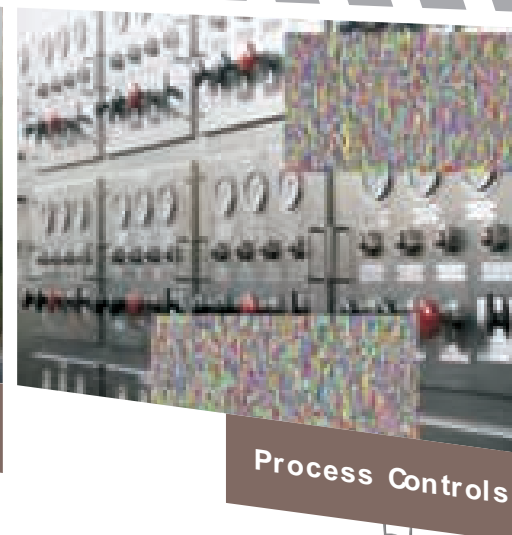

HYDT-STAR's pumps and valves are widely used in various industries. We provide quality products and services with international standard for many well know and outstanding companies worldwide. Choose HYDR-STAR, we will provide you with comprehensive products and professional services.

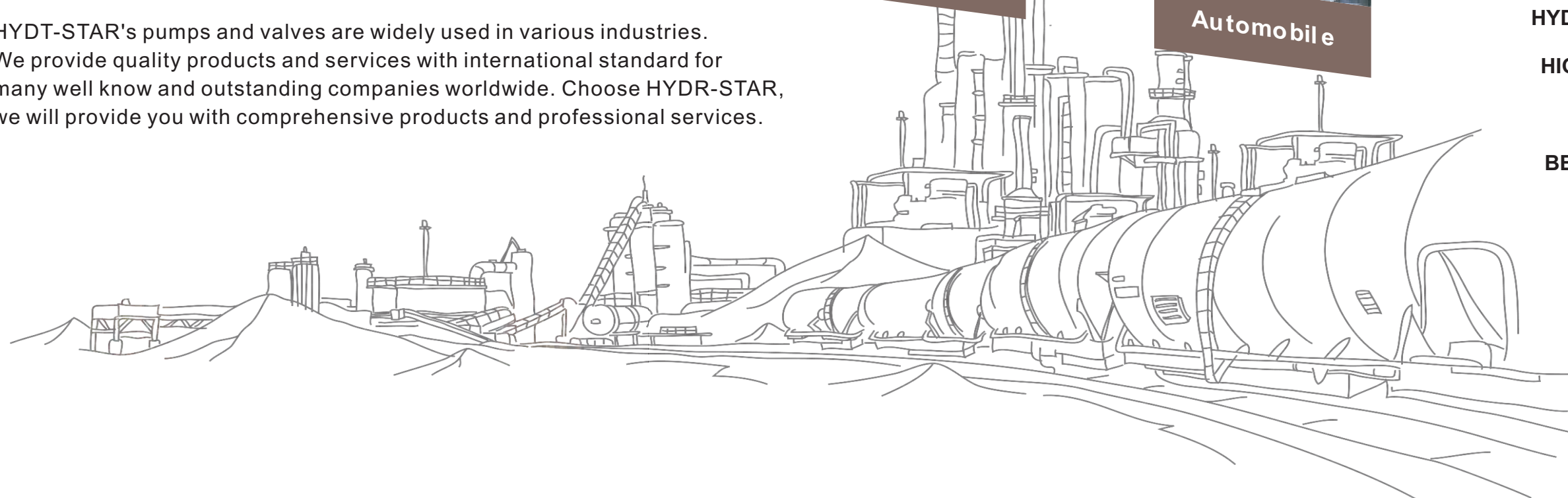

# Contents

OVERVIEW	1
RELAY VALVE	3
INTERFACE VALVE	5
PILOT OPERATED VALVE	9
MANUAL OPERATED VALVE	11
QUICK EXHAUST VALVE	13
PRESSURE SWITCH VALVE	15
GAS REGULATOR & FILTER	17
ESD VALVE	19
INDICATOR	21
SHUTTLE VALVE	23
FLOW CONTROL VALVE	25
VOLUME BOTTLE & ACCUMULATOR	27
VENT FILL CAP & ARRESTOR	28
HYDRAULIC REGULATOR	29
HIGH PRESSURE FILTER	31
GAUGE VALVE	34
BB VALVE & DBB VALVE	35
RELIEF VALVE	37



## About HYDR-STAR

HYDR-STAR Fluid Control Company Limited specialize and focus on the R&D, design and manufacture of stainless steel instrumentation valves, high pressure valves, control valves, high pressure pumps and boosters with international standard.

The company occupies 54 acres and owns 20,000 square meters of modern workshop and office buildings; an engineering team with more than 15 years of professional fluid control technology; advanced testing and manufacturing equipment; complete quality control system; customer oriented, timely and professional sales team and superior services to provide high quality products and solutions for the global fluid control industry.

HYDR-STAR passed the ISO9001 quality management system certification and our products passes SIL and EAC certification. Our products are recognized by clients and customers in Middle East, European Union, Russia, China and other countries.

After years of hard work, HYDR-STAR has become an industry leader and has established list of regular customers from around the globe. Our products are being used in oil&gas, petrochemical, energy, mining, aerospace, military, automotive, firefighting and conventional hydraulic machinery Industries.

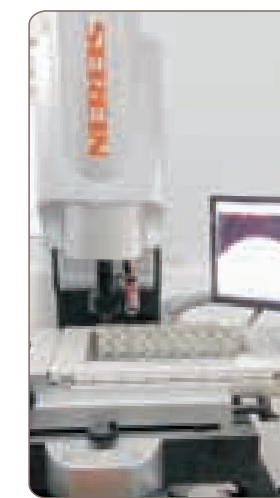

A corner of workshop

High  
Precision  
Lathe

Three  
Coordinate  
Measuring  
Machine

VMC

Warehouse





- ★ 316 stainless steel construction.
- ★ May be used in pneumatic or hydraulic systems.
- ★ Standard Buna N seals, other seals available.
- ★ Type to NACE MR-0175 available.
- ★ Operating force is small.

The 'ARR' indicator relay is a multi-pressure control valve for production control and safety systems. It functions as an automatic reset, pilot operated, normally closed, block and bleed valve. Red indicates that there is no pressure in the pilot chamber. Green indicates that pilot chamber is pressurized.

### Manual Reset Relay

## Indicator Manual Reset Relay

## Indicator Automatic Reset Relay

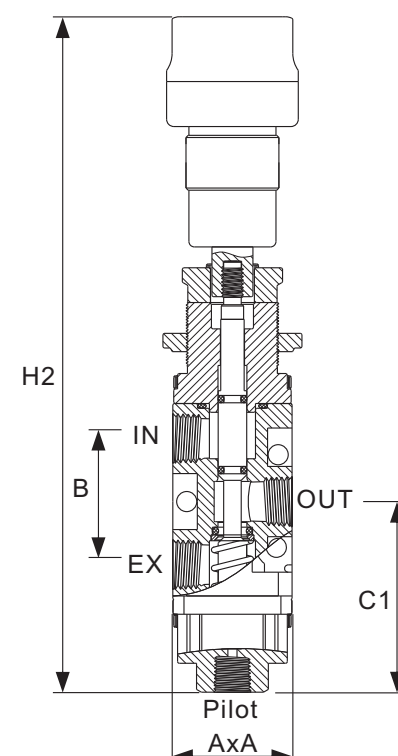
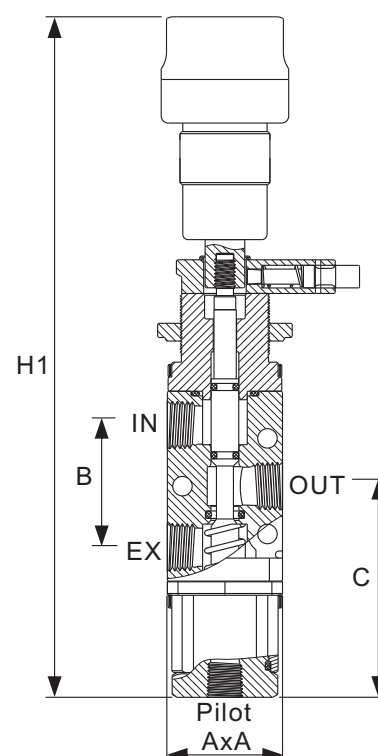
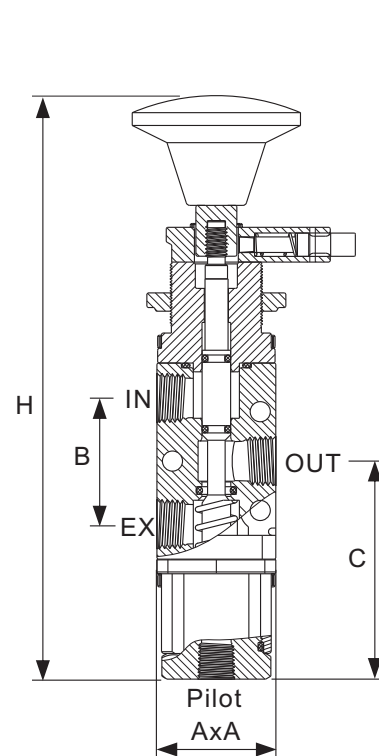

Valve Pressure	MAX.150 psig(10.3 bar)	Pilot Pressure	25~150 psig(1.6~10.3 bar)pneumatic valve
Wetted Material	316 SS,X-750		40~150 psig(2.8~10.3 bar)hydraulic valve
Seal Material	Buna N standard	Work Temperature	-40~250°F(-40~120°C)standard valve
Cv	1.3		



SizeA	1.28 in.(32.5 mm)	Size B	1.36 in.(34.5 mm)
SizeC	2.35 in.(59.6 mm)	Size C1	2.05 in.(52 mm)
SizeH	6.28 in.(159.5 mm)	Size H1	7.56 in.(192 mm)
SizeH2	7.28 in.(185 mm)	Valve Ports	1/4 Female NPT
Panel Hole	1 in.(25.4 mm)	Pilot Port	1/8 Female NPT

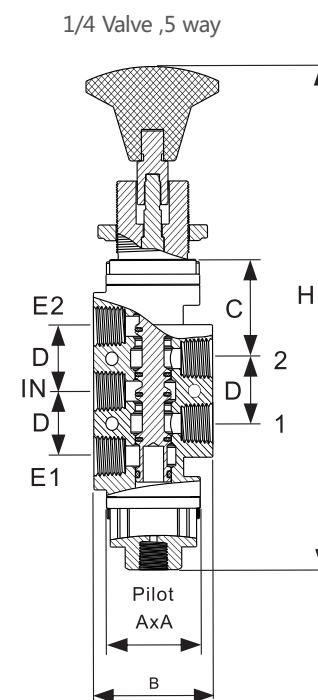

Valve Pressure	MAX.150 psig(10.3 bar)
Pilot Pressure	25~150 psig(1.6~10.3 bar)pneumatic valve
	40~150 psig(2.8~10.3 bar)hydraulic valve
Work Temperature	-40~250 °F(-40~120°C)standard valve
Wetted Material	316,X-750,Buna N standard
Cv	2.1

Size A	1.28 in.(32.5 mm)	Size B	1.63 in.(41.3 mm)
Size C	1.24 in.(31.5 mm)	Size D	0.81 in.(20.6 mm)
Size H	6.38 in.(162 mm) MAX.	Panel Hole	1 in.(25.4 mm)
Valve Port	1/4 Female NPT	Pilot Port	1/8 Female NPT

```

graph TD
    Valve[Valve] --> ValveType[Valve Type]
    Valve --> WithLock[With Lock]
    Valve --> Handle[Handle]
    Valve --> Media[Media]
    Valve --> MR0175[MR-0175]
    
    ValveType --> M[Manual]
    ValveType --> A[Automatic]
    
    WithLock --> O[No]
    WithLock --> L[Yes]
    
    Handle --> B[Black]
    Handle --> R[Red]
    Handle --> G[Green]
    Handle --> D[Indicator]
    
    Media --> H[Hydraulic]
    Media --> P[Pneumatic]
    
    MR0175 --> None[No]
    MR0175 --> N1["-18~120°C, Yes"]
    MR0175 --> N2["-40~120°C, Yes"]
    
    N1 --> N1VT[Valve Type]
    N2 --> N2VT[Valve Type]
    
    N1VT --> N1V3[3 way]
    N1VT --> N1V5[5 way]
    
    N2VT --> N2V3[3 way]
    N2VT --> N2V5[5 way]
    
    N1VT --- N1VT_L[Code]
    N1VT --- N1VT_R[Valve Type]
    N2VT --- N2VT_L[Code]
    N2VT --- N2VT_R[Valve Type]
  
```

The diagram illustrates a hierarchical tree structure for product specifications. The root node is 'Valve'. It branches into five main categories: 'Valve Type', 'With Lock', 'Handle', 'Media', and 'MR-0175'. Each category further branches into specific options. For example, 'Valve Type' branches into 'Manual' and 'Automatic'. 'MR-0175' branches into 'No', '-18~120°C, Yes', and '-40~120°C, Yes'. The '-18~120°C, Yes' and '-40~120°C, Yes' nodes further branch into 'Valve Type' options: '3 way' and '5 way'. The diagram uses a light blue background for the root node and its immediate children, and a light yellow background for the 'MR-0175' node and its sub-nodes. Arrows indicate the flow from parent nodes to child nodes.

Code	Valve Type
M	Manual
A	Automatic

Code	With Lock
O	No
L	Yes

Code	Handle
B	Black
R	Red
G	Green
D	Indicator

Code	Media
H	Hydraulic
P	Pneumatic

Code	MR-0175
None	No
N1	-18~120°C, Yes
N2	-40~120°C, Yes

Code	Body Material
SS	316 SS

Code	Valve Type
none	3 way
5	5way

Other sizes and types available upon request. For special requirements, please contact us.

Repair kit: Contains all seals.

Code	Valve Type
M	Manual
A	Automatic

Code	With Indicator
O	No
D	Yes

Code	Media
H	Hydrsulic
P	Pneumatic

Code	Valve Type
none	3 way
5	5 way

Code	MR-0175
None	No
N1	-18~120°C, Yes
N2	-40~120°C, Yes





# Interface Valve

## Features

- ★ 316 stainless steel construction ( models to NACE MR- 0175 available).
- ★ Large spring load assures fast system response.
- ★ Smooth ball seal assures zero leakage and long life .
- ★ Manual override handle available.

## Description

3-way Interface Valves are normally closed block and bleed Hydraulic Controllers. They allow the system to control Hydraulic pressures as high as 10,000 psi with a relatively low Pilot Supply Hydraulic or Pneumatic pressure.

2-way Interface Valves are normally opened or closed Hydraulic Controllers. They are designed to block incoming hydraulic Supply pressure with a relatively low Pilot Hydraulic or Pneumatic pressure. Valves with manual handles can be operated by the handle. when there is no pilot pressure.



## Construction & Specifications

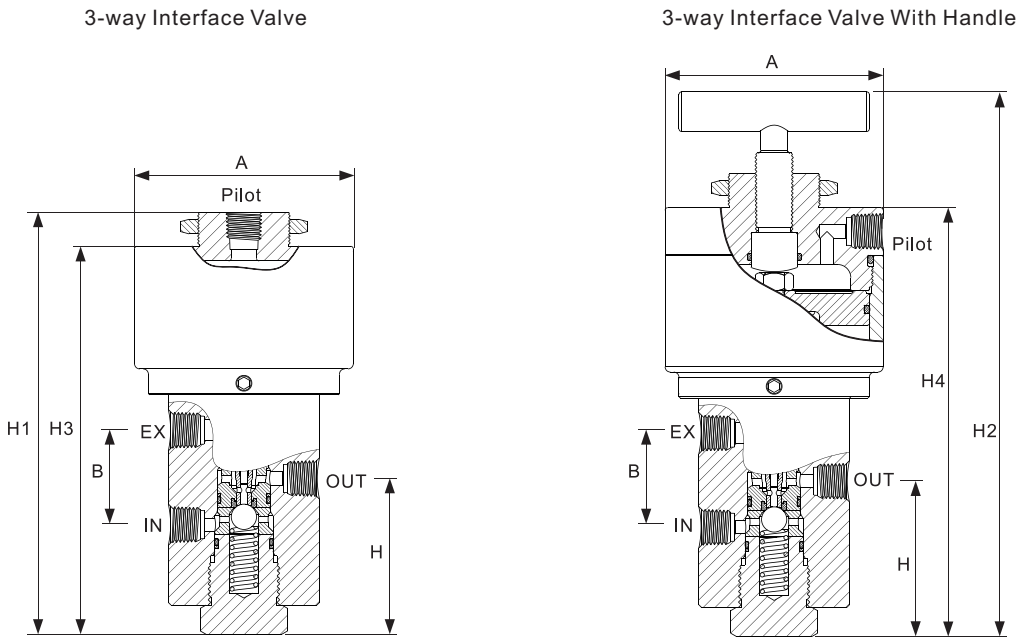

Operate Pressure	MAX.10000 psig(689 bar)
Pilot Pressure	30~150 psig(2-10.3 bar)
Work Temperature	-40~250°F(-40~120°C ) standard valve
Wetted Material	316, 17-4PH
Seal Material	Buna N & PEEK standard

## Dimensions

Size A	3.25 in.(82.5 mm)	Size B	1.4 in.(35.6 mm)
Size H	2.31 in.(58.7 mm)	Size H1	6.26 in.(159 mm)
Size H2	8.11 in.(206 mm)	Size H3	5.76 in.(146.2 mm)
Size H4	6.39 in.(162.2 mm)	Panel Hole	1.38 in.(34.9 mm)
Pilot Port	1/4 Female NPT	Orifice	0.156 in. (4 mm)

## 2-way Interface Valves

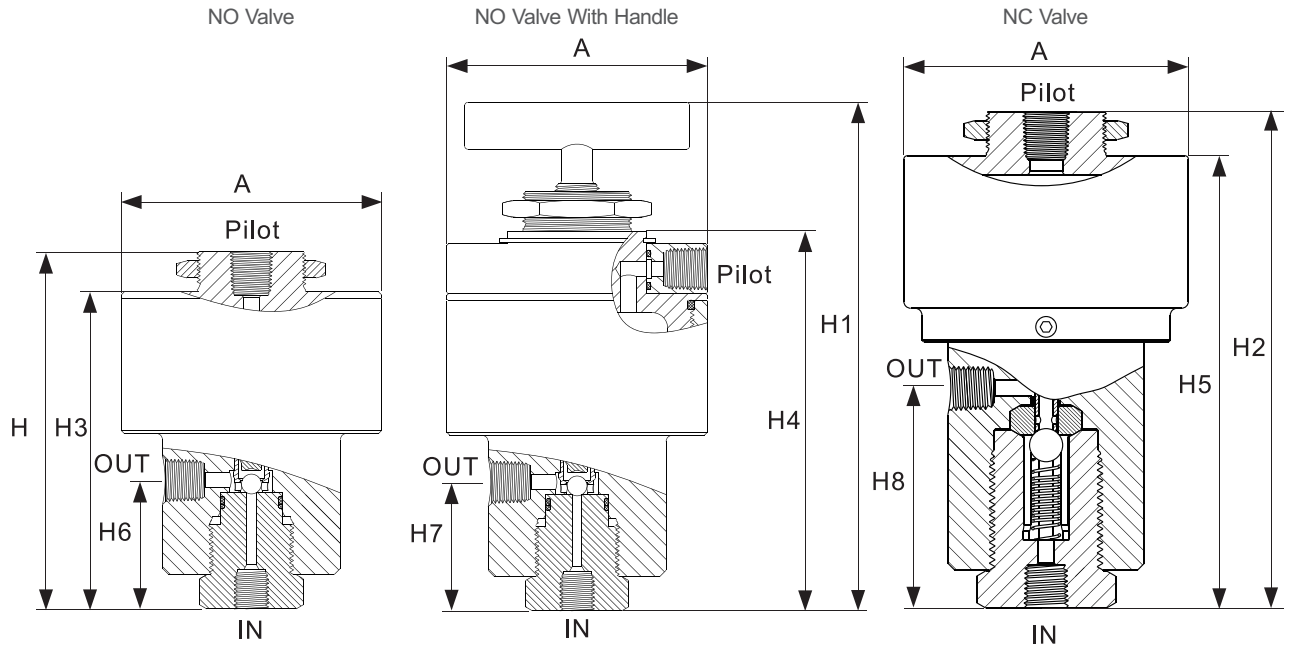

Operate Pressure	MAX.30000 psig (2069 bar)
Pilot Pressure	30-120 psig (2~8 bar)
Work Temperature	-40~250°F(-40~120°C ) standard valve
Wetted Material	316,17-4PH
Seal Material	Buna N

## Dimensions

Size A	3.25 in.(82.5 mm)	Size H	4.5 in.(114.3 mm)
Size H1	6.41 in.(162.8 mm)	Size H2	5.67 in.(143.9 mm)
Size H3	4 in.(101.5 mm)	Size H4	4.78 in.(121.5 mm)
Size H5	5.16in.(131.1 mm)	Size H6	1.62 in.(41.2 mm)
SizeH7	1.62 in.(41.2 mm)	SizeH8	2.51 in.(63.8 mm)
Panel Hole	1.38 in.(34.9 mm)	Orifice	0.156 in. (4 mm) 10000psig
Pilot Port	1/4 Female NPT		0.125 in. (3.2 mm) 20000psig
			0.094 in. (2.3mm) 30000psig

High Pressure Pilot Valves

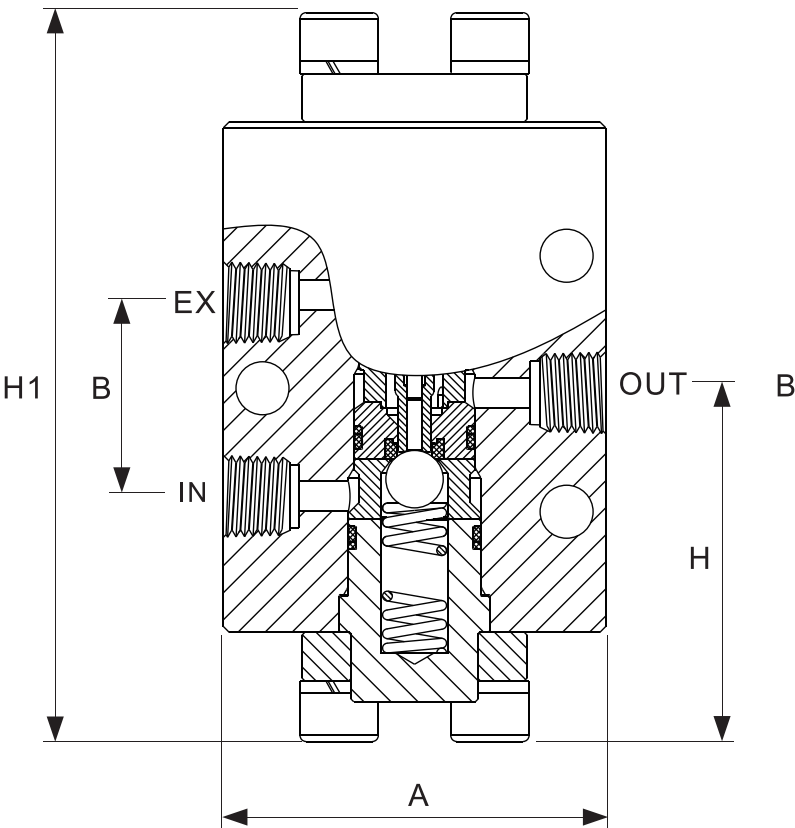

Operate Pressure	MAX.10000 psig (689 bar)
Pilot Pressure	MAX.10000 psig (689bar)
Work Temperature	-40~250°F(-40~120°C ) standard valve
Wetted Material	316,17-4PH
Seal Material	Buna N &PEEK standard

Dimensions

Size A	2.5 in.(63.5 mm)	Size H	2.28 in.(57.9 mm)
Size B	1.28in.(32.5 mm)	Size H1	4.76in.(121 mm)
Valve Ports	1/4Female NPT	Orifice	0.156 in.(4 mm)
Pilot Port	1/4Female NPT		

Ordering code : IFV-10SS-FN4-3A-HN1

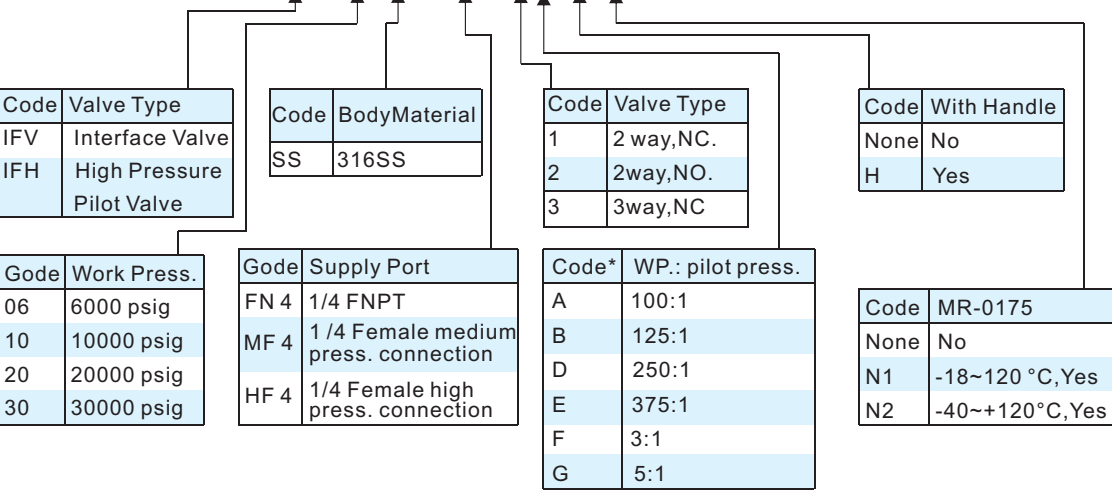

\*D for 20000 psig valve only, E for 30000 psig valve only, F and G for High Pressure Pilot Valve only. Other sizes and types available upon request. For special requirements, please contact us.

Repair Kit

Repair kit: Contains all seals.

Repair Kit Ordering Code: KIT-IFV-2A-20HN1

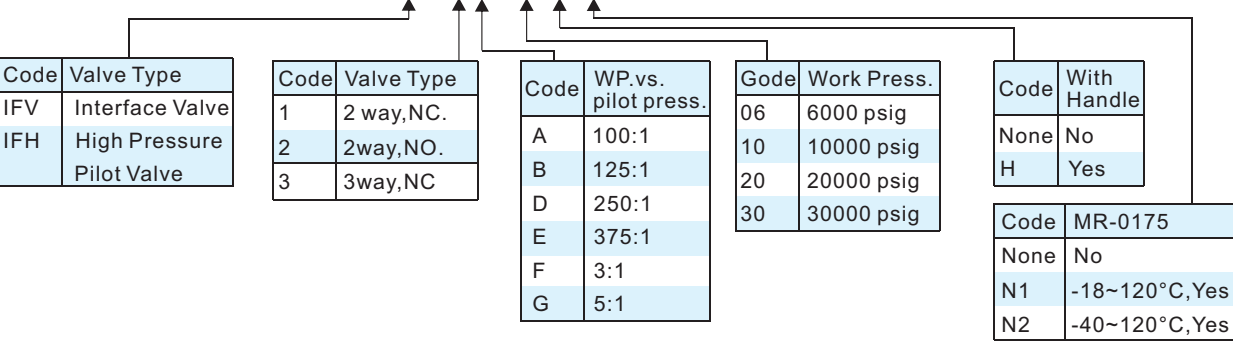



# Pilot Operated Valve

## Features

- ★ 316 stainless steel construction.
- ★ May be used in pneumatic or hydraulic systems.
- ★ Standard Buna N seals, other seals available.
- ★ Large CV factor available.

## Description

The NC valves are normally closed, block and bleed valves. Controlled by a pressure signal applied to a small integral pilot piston that actuates the valve.

The NO valves are normally open, block and bleed valves. Controlled by a pressure signal applied to a small integral pilot piston that actuates the valve.



## Construction & Specifications

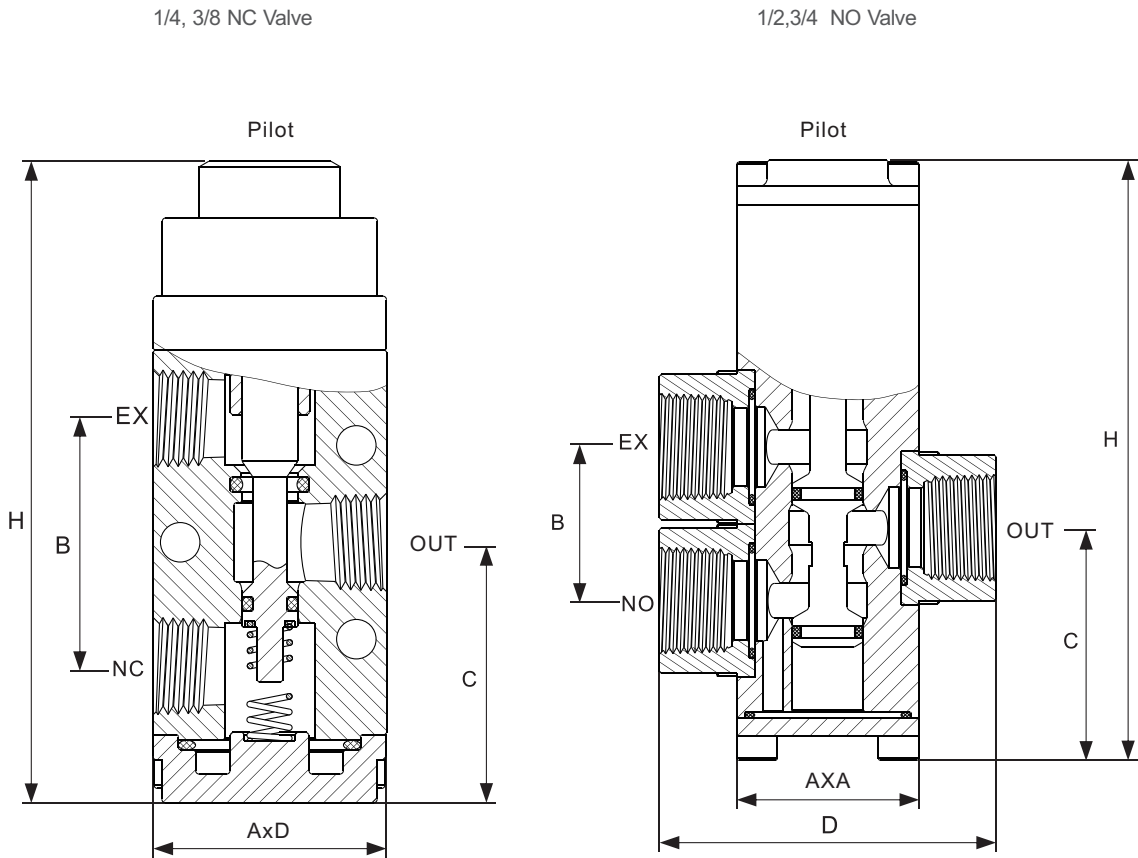

Operate Pressure	MAX.200 psig(13.8 bar)	Wetted Material	316 SS ,X-750,Buna N standard
Pilot Pressure	25~200 psig(1.6~13.8 bar)	Seal Material	Buna N standard
Work Temperature	-40~250°F(-40~120°C)		

Valve Size	Cv	Valve Ports	Pilot Port	A in.(mm)	B in.(mm)	C in.(mm)	D in.(mm)	H in.(mm)
1/4	1.3	1/4 FNPT	1/8 FNPT	1.28(32.5)	1.36(34.5)	1.37(34.8)	1.28(32.5)	3.46(87.9)
3/8	2.1	3/8 FNPT	1/8 FNPT	1.28(32.5)	1.36(34.5)	1.77(45)	1.63(41.3)	3.74(95)
1/2	4	1/2 FNPT	1/4 FNPT	1.5(38.1)	1.49(38)	1.97(50)	2.5(63.5)	4.72(120)
3/4	6.6	3/4 FNPT	1/4 FNPT	1.77(45)	1.49(38)	2.26(57.5)	3.28(83.4)	5.85(148.5)

## Ordering Code : POV-SS-FN4-3A-N1

Code	BodyMaterial	Code	Valve Ports	Code	Valve Type	Code	MR-0175
SS	316SS	FN4	1/4FNPT	3A	3way,NO	None	No
		FN6	3/8 FNPT	3B	3way, NC	N1	-18~120 °C, Yes
		FN8	1/2 FNPT			N2	-40~+120°C, Yes
		FN12	3/4 FNPT				

Other sizes and types available upon request. For special requirements, please contact us.

## Repair Kit

Repair kit: Contains all seals.

## Repair Kit Ordering Code: KIT-POV-V4-N1

Code	Valve Size	Code	MR-0175
V4	1/4	None	No
V6	3/8	N1	-18~120 °C, Yes
V8	1/2	N2	-40~+120°C, Yes
V12	3/4		

# Manual Operated Valve

## Features

- ★ 316 stainless steel construction.
- ★ May be used in pneumatic or hydraulic systems.
- ★ Standard Buna N seals, other seals available.
- ★ Operating force is small.
- ★ Type to NACE MR-0175 available.

## Description

The 3 way NC valves are normally closed, block and bleed valves. Push the manual handle to open the valve. Release the handle, spring return to close the valve.

The 3 way NO valves are normally open, block and bleed valves. Push the manual handle to close the valve. Release the handle, spring return to open the valve.

The 5 way valves are two position, five-way valves. When pull the handle, port 1 (one of the two out ports) will on pressure, port 2 (another out port) will to exhaust. When push the handle, port 2 will on pressure port 1 will to exhaust.

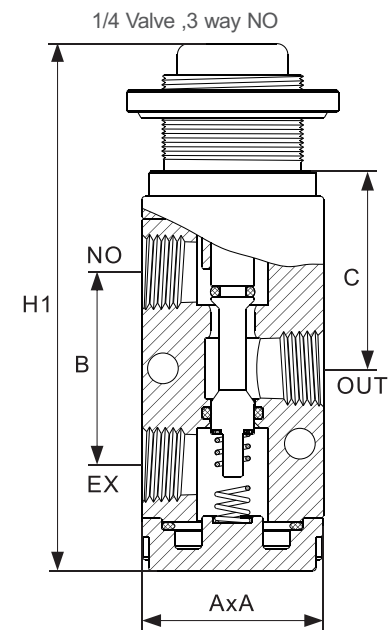
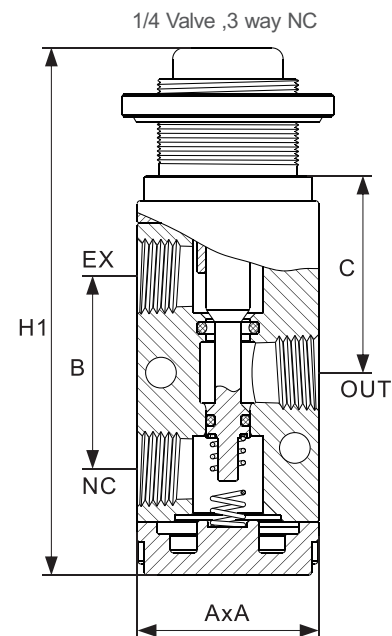

Operate Pressure	MAX.200 psig(13.8 bar)	Wetted Material	316,X-750,Buna N standard
Work Temperature	-40~250 °F ( -40~120°C)standard valve	Spring Material	X-750

## Construction & Specifications

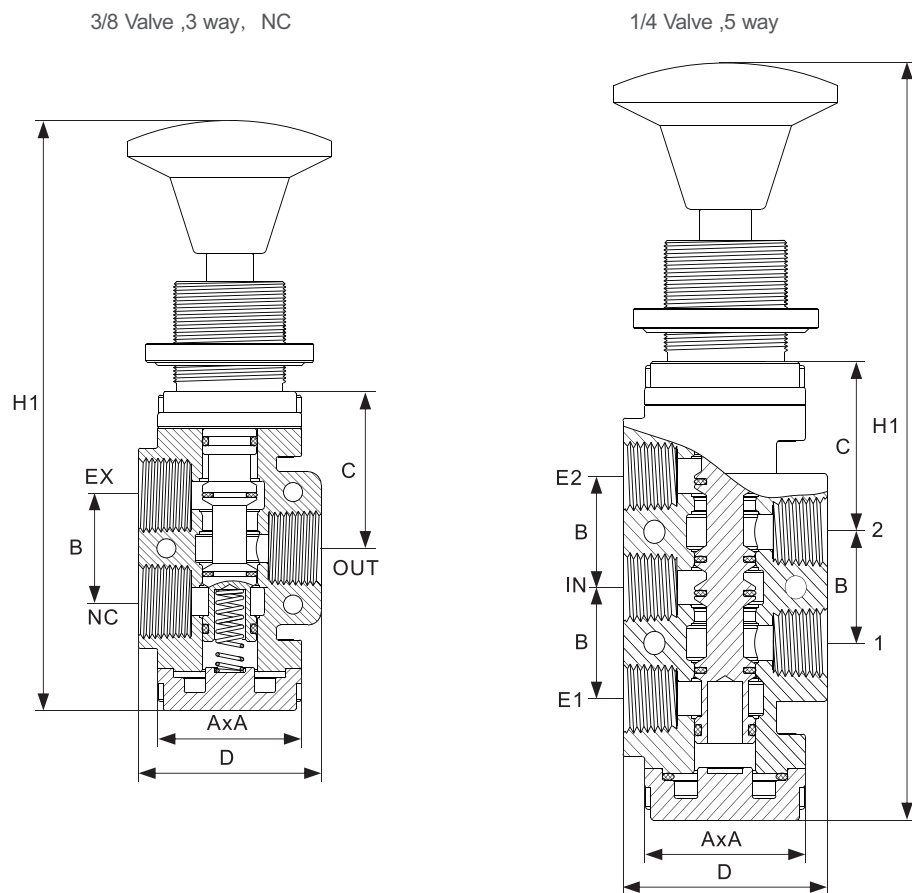

## Dimensions

in.(mm)

Valve Size	Valve Type	Ports	A	B	C	D	H1	Cv	Panel Hole
1/4	5 way	1/4 NPT	1.28(32.5)	0.81 (20.6)	1.24(31.5)	1.62(41.3)	5.8(146.2)	2.1	1.28(32.5)
3/8	3 way NC	3/8 NPT	1.28(32.5)	0.94(24)	1.38(35.3)	1.62(41.3)	5.2(133.2)	2.7	1.28(32.5)
1/4	3 way NC	1/4 NPT	1.28(32.5)	1.36(34.5)	1.78(45.2)	-	3.5(89.4)	1.3	1.28(32.5)
1/4	3 way NO	1/4 NPT	1.28(32.5)	1.36(34.5)	1.78(45.2)	-	3.5(89.4)	1.3	1.28(32.5)

## Ordering code : MOV-SS-FN4-3A-N1

Code	Body Material	Code	Valve Ports	Code	Valve Type	Code	MR-0175
SS	316 SS	FN 4	1/4 FNPT	3A	3 way, NO	None	No
		FN 6	3/8 FNPT	3B	3 way, NC	N1	-18~120°C, Yes
				5A	5 way, Spring return	N2	-40~120°C, Yes
				5B	5 way, without spring		

Other sizes and types available upon request. For special requirements, please contact us.

## Repair Kit

Repair kit: Contains all seals.

## Repair Kit Ordering Code: KIT-MOV-3-V4-N1

Code	Valve Type	Code	Valve Size	Code	MR-0175
3	3 way	V4	1/4	None	No
5	5 way	V6	3/8	N1	-18~120°C, Yes
				N2	-40~+120°C, Yes





# Quick Exhaust Valve

### Features

- ★ 316 stainless steel construction.
- ★ Large CV factor assures fast system response.
- ★ Small operating noise.
- ★ Type to NACE MR-0175 available.
- ★ Standard Buna N seals, other seals available.

### Description

The quick exhaust Valve is designed to rapidly bleed the control pressure from an actuator or other device .It is typically used on safety valves, control valves, or other devices that must respond quickly when the control signals are removed . It is easy to install and maintain. No special tools are needed for repair and assembly.



### Construction & Specifications

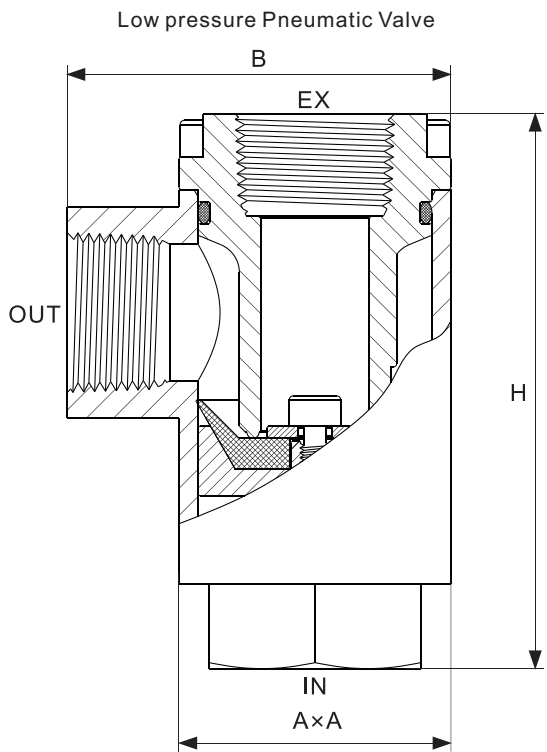

Working Pressure	MAX.200 psig(13.8 bar)	Wetted Material	316 & Buna N standard
Inlet Cracking Press.	5 psig(0.3 bar)	Work Temperature	-40~250 °F( -40~120°C)standard valve

### Dimensions

Valve Size	Valve Ports	H in.(mm)	A in.(mm)	B in.(mm)	Cv Factor (IN)	Cv Factor (EX)
1/2	1/2 FNPT	3.25(88.9)	1.50(38.1)	2.25(57.2)	5.4	7.6
3/4	3/4 FNPT	3.61 (91.8)	1.75(44.5)	2.50(63.5)	6.6	9.8

High Pressure Hydraulic Valve, size 1/2

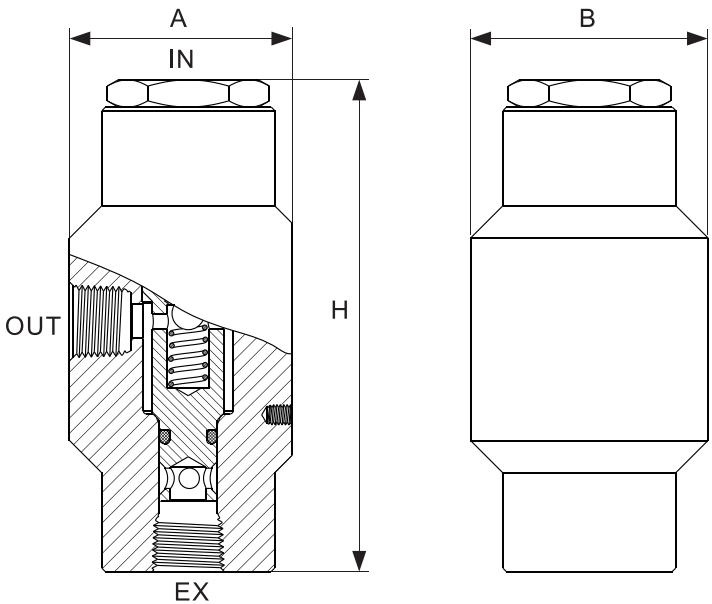

Working Pressure	MAX.10000 psig(689 bar)	Inlet Cracking Press.	80 psig(5.5 bar)
Wetted Material	316,X-750 & Buna N standard	Valve Ports	1/2 Female NPT
Work Temperature	-40~250°F(-40~120°C )standard	Size A	2.58 in.(65.5mm)
Size B	2.75 in.(69.8mm)	CV Factor (IN)	1.1 for 689bar, 1 .4 for 414 bar
Size H	5.69 in.(144.5mm)	CV Factor (EX)	5.4 for 689bar, 7 for 414 bar

### Ordering Code : QEV-10SS-FN8-H-N1

Code	Work Press.	Code	Body Material	Code	Valve Ports	Code	Media	Code	MR-0175
D2	200 psig	SS	316 SS	FN8	1/2Female NPT	P	Pneumatic	None	No
06	6000 psig			FN12	3/4Female NPT	H	Hydraulic	N1	-18~120°C, Yes
10	10000 psig							N2	-40~120°C, Yes

6000 psig and 10000 psig just for hydraulic valve. Other sizes and types available upon request. For special requirements, please contact us.

### Repair Kit

Repair kit: Contains all seals.

### Repair Kit Ordering Code : KIT-QEV-10-8-H-N1

Code	Work Press.	Code	Valve Size	Code	Media	Code	MR-0175
D2	200 psig	8	1/2	P	Pneumatic	None	No
06	6000 psig	12	3/4	H	Hydraulic	N1	-18~120°C, Yes
10	10000 psig					N2	-40~120°C, Yes



# Pressure Switch Valve

## Features

- ★ 316 stainless steel construction (models to NACE MR-0175 available).
- ★ Hydraulic and Pneumatic service.
- ★ Designed for 1% plus or minus repeatability on set point.
- ★ Minimum dead band between trip and reset, about 5%.

## Description

These valves are operated by the pressure applied to the sense port acting on a piston opposing an adjustable spring force. 3 way valve is a block and bleed valve. It functions as either a normally closed or normally open valve, depending on through which port the instrument pressure is supplied. These ports are marked as 'HI IN' or 'LO IN' on the switch body. The output port, marked 'OUT' on the switch body, is the same for either mode of operation. 2 way valve is functions as a normally closed or normally open valve, depending on customer requirement. See Valve Ordering Code.

## Construction & Specifications



MAX. Valve Pressure	150 psig (10. 3 bar) for 3 way valves	Valve Part Wetted Material	316 & Buna N
MAX. Valve Pressure	6000 psig ( 414 bar) for 2 way valves	Sense Part Wetted Material	316, Buna N standar
Sense Pressure	10~10000psig (0.7~689bar)	Cv Factor (2 way valves)	0.12
Work Temperature	-40 250 °F(-40~120°C standard	Cv Factor (3 way valves)	0.09

## Dimensions

in.(mm)

A	2(50.8)	D	7(177.8)	S	1.25(31.8)	Valve Sense Port	1/4 FNPT & 1/2 MNPT
B	4.31(109.5)	E	3.86(98)	H	11.5(292.1)MAX.	Assembly Sense Port	1/2FNPT
C	3.86(98)	F	0.91(23)	P	1.78(45.2)	Valve Port	1/4 FNPT

### Sense Pressure Ranges

Spring Code &(Colour)	Piston Code & (Size)		
	1 (0. 22 in. 5.6mm)	2(0.56 in. 14.3mm)	3(1.25 in. 31.7mm)
Y(Yellow)	10000~6000psig(689~414 bar)	1500~750psig( 103~51.7 bar)	×
R(Red)	6000~3000psig(414~207 bar)	900~400psig(62~27.6 bar)	200~80psig(13.8~5.5 bar)
G(Green)	3000~1500psig(207~103 bar)	450~200psig(27.6~13.8 bar)	100~30psig(6.9~2 bar)
P(Purple)	×	×	45~10psig(3.1~ 0.7 bar)

## Valve Ordering Code: PSV-SS-2R-3A-N1

Code	Body Materiel	Code	Piston	Code	Spring	Code	Valve Type&Press.	Code	MR-0175
SS	316 SS	1	0.22in.	Y	Yellow	3A	3Way,150psig	None	No
A825	Inconel 825	2	0.56in.	R	Red	2A	2way,NO,6000psig	N1	-18~120°C, Yes
M400	Monel 400	3	1.25in.	G	Green	2B	2way,NC,6000psig	N2	-40~120°C, Yes
H276	HC-276			P	Purple				

Other sizes and types available upon request. For special requirements, please contact us.

## Repair Kit

Repair kit: Contains all seals & spring.

## Repair Kit Ordering Code:KIT-PSV-2R-3A-N1

Code	Piston	Code	Spring	Code	Valve Type&Press.	Code	MR-0175
1	0.22in.	Y	Yellow	3A	3Way,150psig	None	No
2	0.56in.	R	Red	2A	2way,NO,6000psig	N1	-18~120°C, Yes
3	1.25in.	G	Green	2B	2way,NC,6000psig	N2	-40~120°C, Yes
		P	Purple				

## Valve Assembly Ordering Code: PSA-SS-2R3G-3A-N1

Code	Sensor Materiel	Code	Piston	Code	Spring	Code	Piston	Code	Spring	Code	Valve Type	Code	MR-0175
SS	316 SS	1	0.22in.	Y	Yellow	1	0.22in.	Y	Yellow	3A	3Way	None	No
A825	Inconel 825	2	0.56in.	R	Red	2	0.56in.	R	Red	2A	2way,NO	N1	-18~120°C, Yes
M400	Monel 400	3	1.25in.	G	Green	3	1.25in.	G	Green	2B	2way,NC	N2	-40~120°C, Yes
H276	Hc-276			P	Purple			P	Purple				

The first piston code means The piston of the higher pressure valve in the assembly. So as the first spring code. The second piston code means The piston of the lower press. valve in the assembly. So as the second spring code.

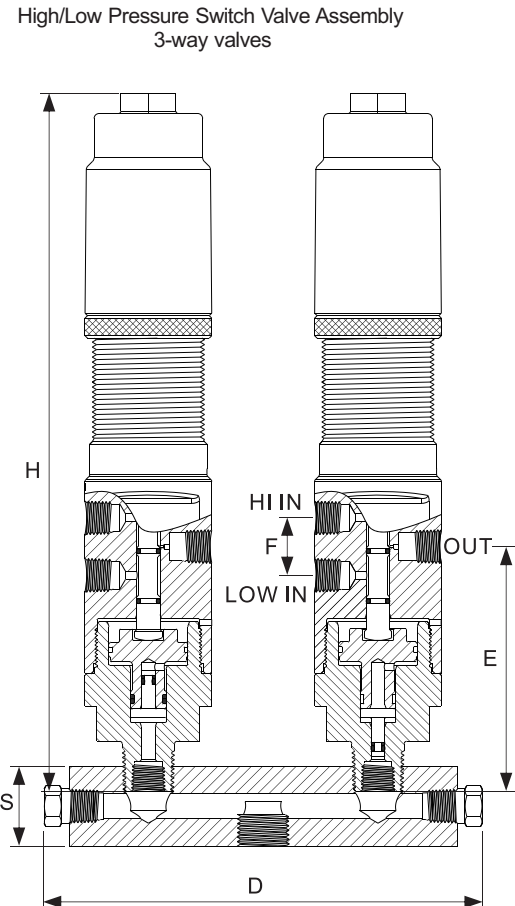
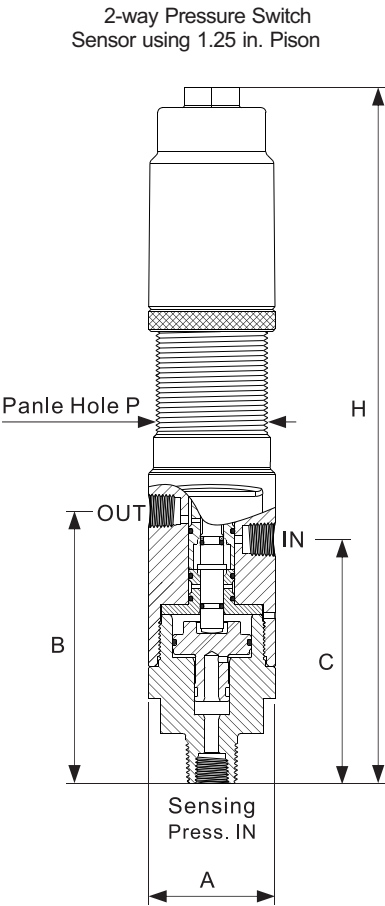



# Gas Regulator & Filter

## Features

- ★ 316 stainless steel construction.
- ★ Standard Buna N seals, other seals available.
- ★ Type to NACE MR-0175 available.
- ★ Operating torque is small.
- ★ Relief port will prevent excessive build up of down stream pressure.

## Description

The FR and AR valves are gas reducing regulators. The down stream pressure can be accurately set through a set handle. Every valve has a relief port can prevent excessive build up of down stream pressure. Not like FR valves, AR valves do not with filter. All FR & AR valves and Filters can stand up to the harshest environments, such as sour gas and off-shore environments. Valves or Filters with drains can artificial drainage.

## Construction & Specifications

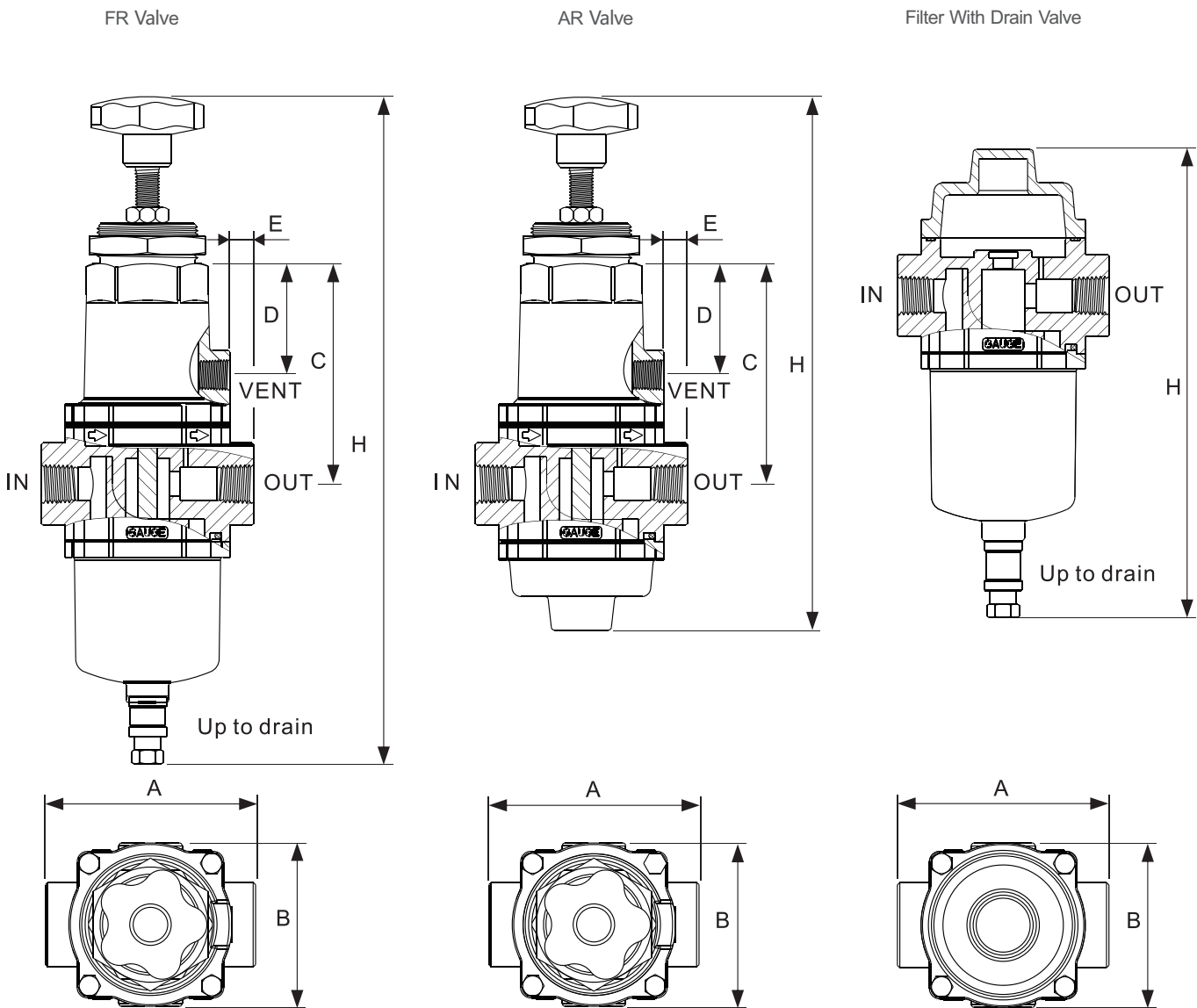

Inlet Pressure	MAX.300 psig(20. 7 bar)	Wetted Material	316,X -750
Outlet Pressure	0-150 Psig(0~10.3bar) Regulator	Seal Material	Buna N standard
	MAX.300 Psig(0~20.7bar) Filter	Element Pore Size	25um
Work Temperature	-40~250°F(-40~120°C)standard valve	Media	Natural gas, N2, Air

## Dimensions

in.(mm)

Type	Valve Ports	A	B	C	D	E	H
FR	1/4 or 1/2NPT	2. 74(69.5)	2.13 (54)	1.48(37.5)	2. 88(73.2)	0.3(7.7)	8.66(220)
AR	1/4 or 1/2NPT	2. 74(69.5)	2.13(54)	1.48(37.5)	2. 88(73.2)	0.3(7.7)	6.89(175)
FT	1/4 or 1/2NPT	2. 74(69.5)	2.13(54)				6.61(168)

Flow base on 100 psi

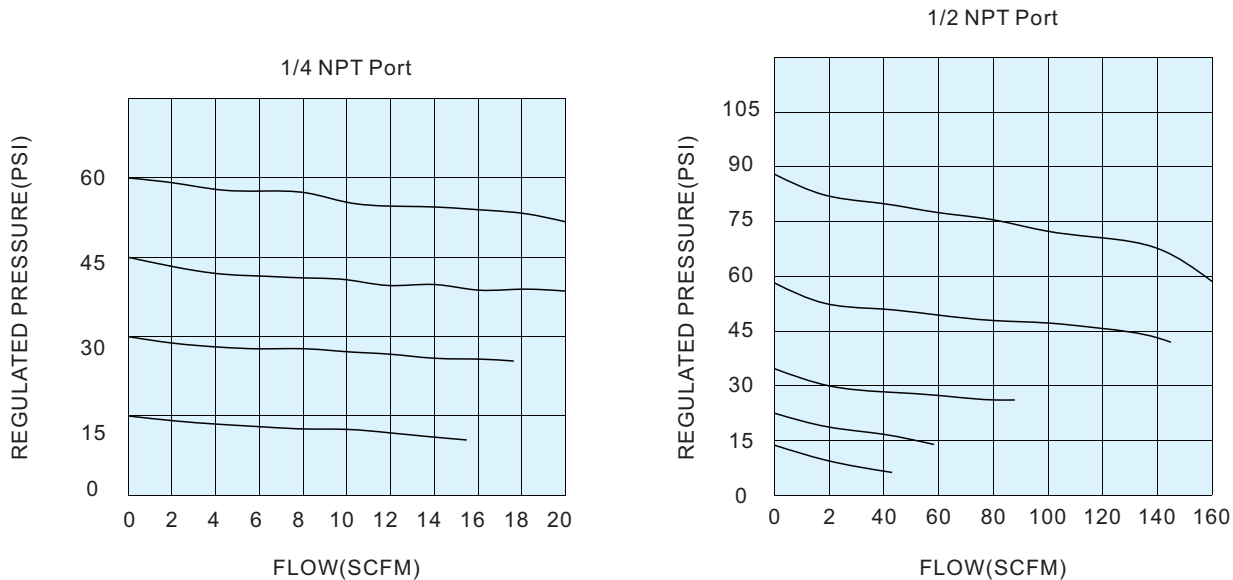

## Ordering code: AR-D3SS-FN4-AN1

Code	Valve Type	Code	Body Materiel	Code	Valve Ports
AR	Regulator	SS	316 SS	FN4	1/4Female NPT
FR	Regulator with Filter			FN8	1/2Female NPT
FT	Filter	Code	Inlet Press.	Code	Output Range
		D3	300 Psig	A	0-100 psig,regulator
				B	0-150 psig,regulator
				None	Filter,the same as inlet
				Code	MR-0175
				None	NO
				N1	-18~120°C, Yes
				N2	-40~120°C, Yes

Drain Valve is just for FR&FT valves.  
Other sizes and types available upon request.  
For special requirements, please contact us.

## Repair Kit

Repair kit:Contains all seals.

## Repair Kit Ordering Code:KIT-AR-D3-N1

Code	Valve Type	Code	Inlet Press.	Code	MR-0175
AR	Regulator	D3	300 Psig	None	NO
FR	Regulator with Filter			N1	-18~120°C, Yes
FT	Filter			N2	-40~120°C, Yes



# ESD Valve

## Features

- ★ 316 stainless steel construction.
- ★ May be used in pneumatic or hydraulic systems.
- ★ Standard Buna N seals, other seals available.
- ★ Type to NACE MR-0175 available.
- ★ Operating force is small.
- ★ Large Cv factor provides a fast system response.
- ★ Easily repaired without removing valve from panel.

## Description

The ESD Valves are two way or three way valves used to close or exhaust a system. They are typical used in Emergency Shutdown (ESD) control circuits to immediately close SSV or SDV Actuators and Surface Controlled SubSurface Safety Valves. Push the handle to operate the valve. The valve push to exhaust is normally closed. The valve push to close is normally opened.

## Construction & Specifications

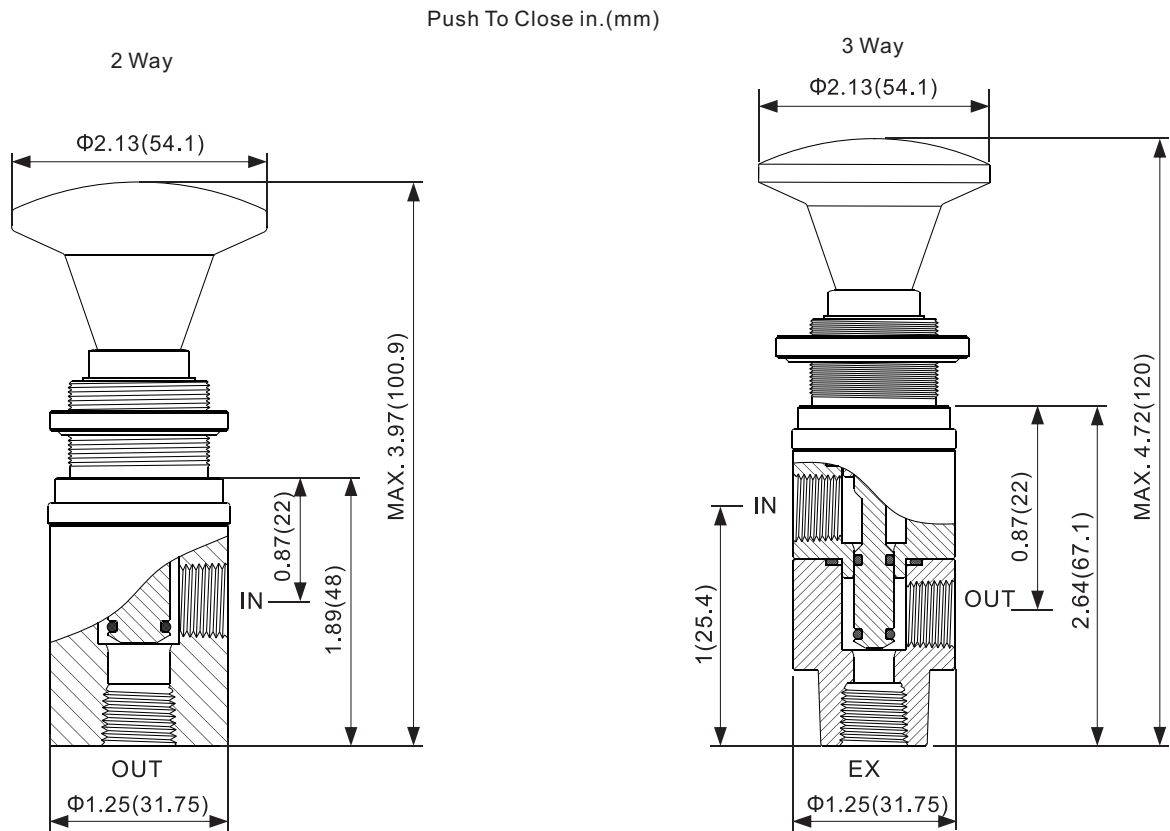
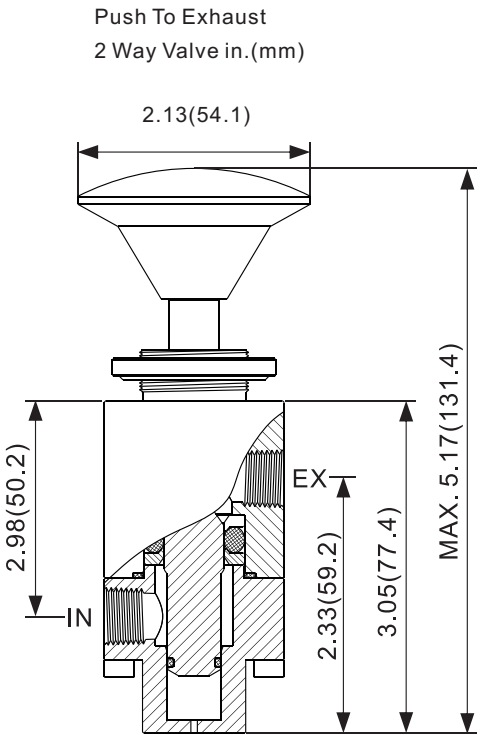

Work Pressure	MAX.200 psig(10.3 bar)	Ports Size	1/4 Female NPT
Work Temperature	-40~250°F(-40~120°C)standard valve	Panel Hole	1 in.(25.4 mm)
Orifice	2 Way:11mm 3 Way:8 mm	Wetted Material	316,Buna N standard

Work Pressure	MAX.200 psig(13.8 bar)	Ports Size	1/4 Female NPT
Work Temperature	-40~250°F(-40~120°C)standard valve	Orifice	0.55 in.(14mm)
Wetted Material	316,Buna N standard	Panel Hole	1 in.(25.4 mm)

## Ordering code : ESV-SS-FN4-2B-PE-N1

Code	Body Materiel	Code	Ports	Code	Valve Type	Code	Handle	Code	Valve Type	Code	MR-0175
SS	316 SS	FN4	1/4FNPT	2	2-way	R	Red	PC	Push to close	None	No
				3	3-way	B	Black	PE	Push to exhaust	N1	-18~120°C,Yes
						G	Green			N2	-40~120°C,Yes

Other sizes and types available upon request. For special requirements, please contact us.

## Repair Kit

Repair kit:Contains all seals.

## Repair Kit Ordering Code:KIT-ESV-2-PE-N1

Code	Valve Type	Code	Valve Type	Code	MR-0175
2	2-position,2-way	PC	Push to close	None	No
3	2-position,3-way	PE	Push to exhaust	N1	-18~120°C,Yes
				N2	-40~120°C,Yes



# Indicator

## Features

- ★ 316 stainless steel construction.
- ★ May be used in pneumatic or hydraulic systems.
- ★ Standard Buna N seals, other seals available.
- ★ Type to NACE MR-0175 available.

## Description

The Indicator provides visual indication of pressure in a system. when system pressure is up to the minimum display pressure,the indicator displays a green field marked with the recognition character "G". Complete loss of pressure causes the indicator to display a red field, marked with the recognition character "R".

The low pressure indicator is used for system pressure up to 200 psig. The high pressure indicator is used for system pressure up to 10000psig.

The Trip Indicator will display a red field to show that the corresponding sensing device in a safety control system has tripped. It will keep red until manually reset.



## Construction & Specifications

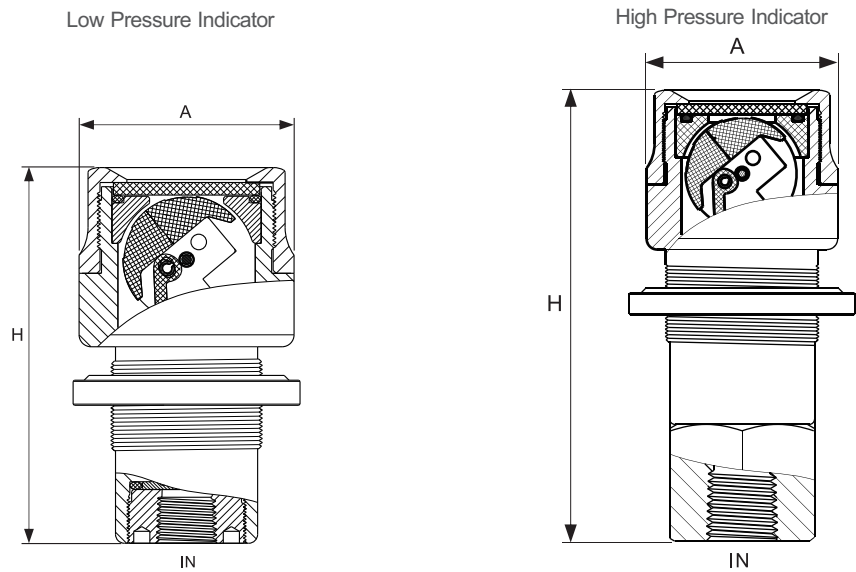

Low Pressure Indicator

Work Pressure	MAX.200 psig(13.8 bar)	Size A	1.42 in.(36 mm)
MIN.Display Pressure	20 psig(1.4 bar) Pneumatic	Size H	2.48 in.(63 mm)
MIN.Display Pressure	35 psig(2.4 bar) Hydraulic	Panel Hole	1 in.(25.4mm)
Work Temperature	-40~250°F ( -40~120°C) standard valve	Port Size	1/8 Female NPT
Wetted Material	316 SS		

High Prssure Indicator

Operate Pressure	MAX.10000 psig(689 bar)	SizeA	1.42 in.(36 mm)
MIN.Display Pressure	120 psig(8.2 bar)	Size H	3.49 in.(88.7 mm)
Work Temperature	-40~250°F (-40~120°C)standard valve	Panel Hole	1.13 in.(28.6mm)
Wetted Material	316 SS	Port Size	1/8 Female NPT
Seal Material	Buna N standard		

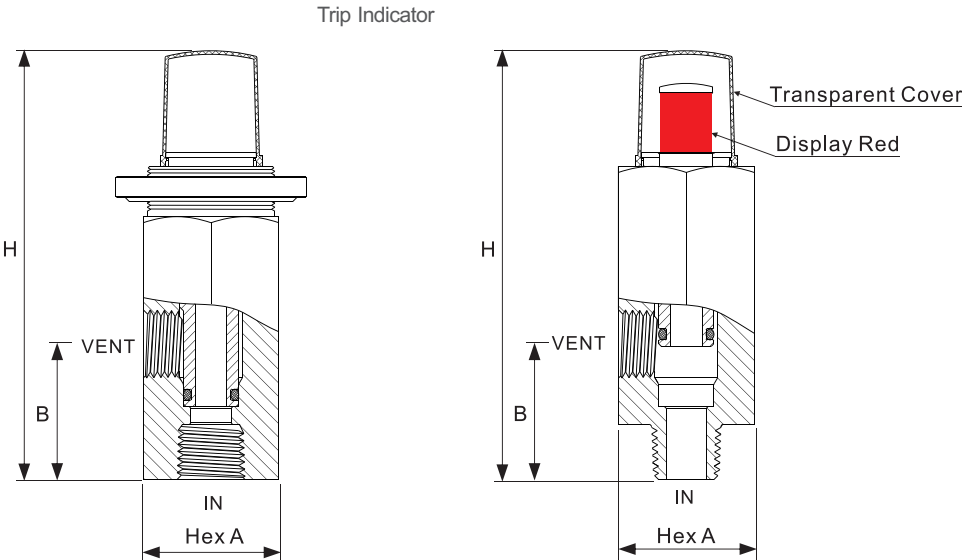

MIN.Display Pressure	MAX. 3 Psig(0.2bar)Pneumatic	SizeA	1 .06 in.(27 mm)
MIN.Display Pressure	MAX.15 psig(1 bar)Hydraulic	Size B	1.06 in.(27 mm)
MAX.Vent Pressure	200 Psig(13.8 bar) Pneumatic	Size H	3.35 in.(85mm)
MAX.Vent Pressure	6000 psig(414 bar)Hydraulic	Panel Hole	1 in.(25.4 mm)
work Temperature	-40~250°F (-40~120°C)standard	Inlet Port	1/4 Female NPT or 1/4 Male NPT
Wetted Material	316 SS & Buna N standard	Vent Port	1/4 Female NPT

## Ordering Code: IDV-10SS-FN2-H-N1

Code	Type	Code	Body Material	Code	Supply Port	Code	MR-0175
IDV	Indicator	SS	316SS	FN 2	1/8 FNPT	None	No
IDT	Trip Indicator			FN 4	1/4 FNPT	N 1	-18~120°C, Yes
				MN 4	1/4 MNPT	N 2	-40~120°C, Yes
Code	Work Press	Code	Media				
None	200psig for IDV	P	Pneumatic				
None	For IDT	H	Hydraulic				
10	10000psig						

Other sizes and types available upon request. For special requirement s, please contact us

## Repair Kit

Repair kit:Contains all seals.

## Repair Kit Ordering Code : KIT-IDV-H-N1

Code	Type	Code	Media	Code	MR-0175
IDV	Indicator	P	Pneumatic	None	No
IDT	Trip Indicator	H	Hydraulic	N 1	-18~120°C, Yes
				N 2	-40~120°C, Yes





# Shuttle Valve

### Features

- ★ 316 stainless steel construction.
- ★ Large CV factor assures fast system response.
- ★ Small operating noise.
- ★ May be used in pneumatic or hydraulic systems.
- ★ Type to NACE MR-0175 available.

### Description

The Shuttle Valve is a two inlet, one outlet device utilizing a free moving shuttle which blocks one of two inlet ports while allowing the unblocked inlet port to flow to the outlet. When a pressure signal is applied to one of the inlet ports, the shuttle shifts blocking off the opposite inlet port and flow goes through the outlet.



### Construction & Specifications

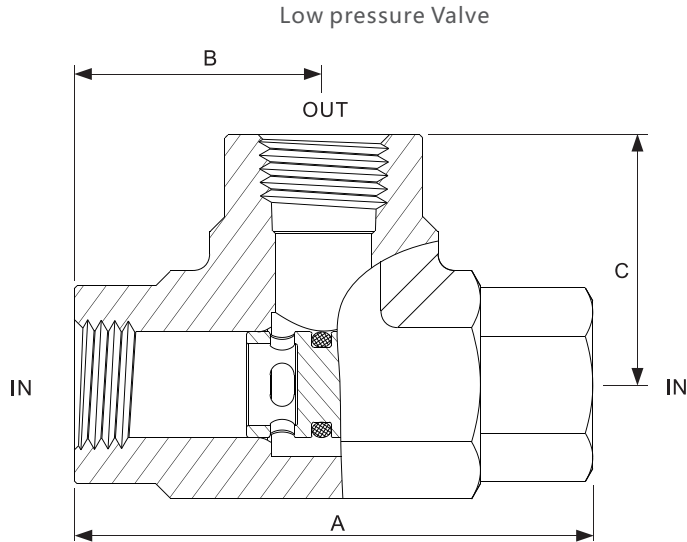

Work Pressure	MAX.200 psig(13.8 bar)
Work Temperature	-40~ 250°F (-40~120°C) standard
Wetted Material	316 SS & Buna N standard
Media	Pneumatic & Hydraulic

### Dimensions

Valve Ports	Orifice	A	B	C	Body Hex
1/4 FNPT	0.28 in.(7.1 mm)	2.13 in.(54 mm)	1.02 in.(26 mm)	1.02 in.(26 mm)	0.81 in.(20.6 mm)
3/8 FNPT	0.36 in.(9.2 mm)	2.24 in.(57 mm)	1.06 in.(27 mm)	1.06 in.(27 mm)	0.94 in.(23.8 mm)
1/2FNPT	0.5 in.(12.7 mm)	2.56 in.(65 mm)	1.18 in.(30 mm)	1.18 in.(30 mm)	1.06 in.(27 mm)

### High Pressure Hydraulic Valve

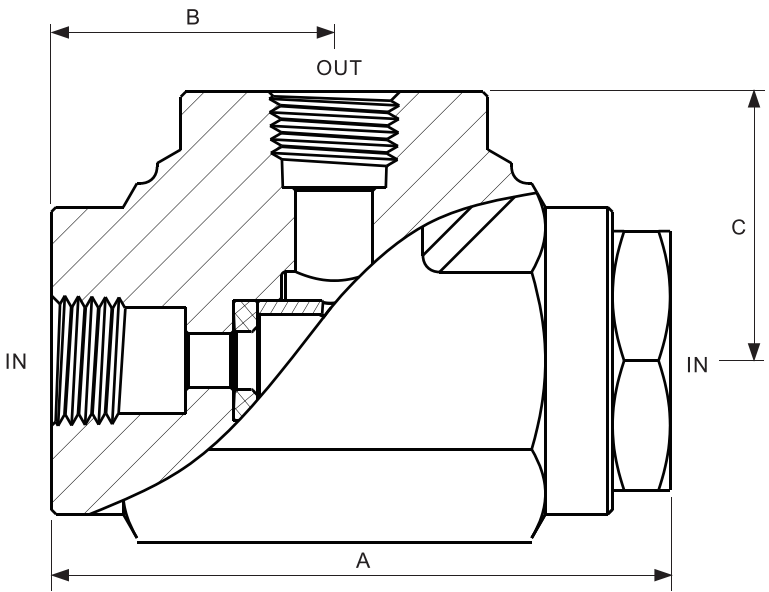

Working Pressure	MAX.10000 psig(689 bar)
Work Temperature	-40~250°F ( 40 ~120°C)standard
Wetted Material	316 SS, PEEK & Buna N standard
Media	Hydraulic

### Dimensions

Valve Ports	Orifice	A	B	C	Body Hex
1/4 FNPT	0.22 in.(5.6mm)	2.54 in.(64.5 mm)	1.16 in.(29.5mm)	1.1 in.(28mm)	1.5 in.(38.1mm)
3/8 FNPT	0.33 in.(8.4 mm)	2.54 in.(64.5 mm)	1.16 in.(29.5mm)	1.1 in.(28mm)	1.5 in.(38.1mm)

### Ordering Code:STV-10SS-FN4-H

Code	Work Press	Code	Body Material	Code	Valve Port	Code	Media
None	200 psig	SS	316SS	FN 4	1/4 Female NPT	P	Pneumatic
10	10000 psig			FN 6	3/8 Female NPT	H	Hydraulic
				FN 8	1/2 Female NPT		

10000 psig just for hydraulic valves.Other sizes and types available upon request.  
For special requirements, please contact us.

### Repair Kit

Repair kit:Contains all seals.

### Repair Kit Ordering Code:KIT-STV-10-4-H

Code	Work Press	Code	Valve Size	Code	Media
D2	200 psig	4	1/4 NPT port	P	Pneumatic
10	10000 psig	6	3/8 NPT port	H	Hydraulic
		8	1/2 NPT port		



# Flow Control Valve

### Features

- ★ 316 stainless steel construction.
- ★ May be used in pneumatic or hydraulic systems.
- ★ Standard Buna N seals, other seals available.
- ★ Type to NACE MR-0175 available.
- ★ Operating force is small.
- ★ Large Cv factor provides a fast system response.

### Description

From port P to port A, the valve as a Throttle valve. And from port A to port P, the valve as a check valve.



### Construction & Specifications

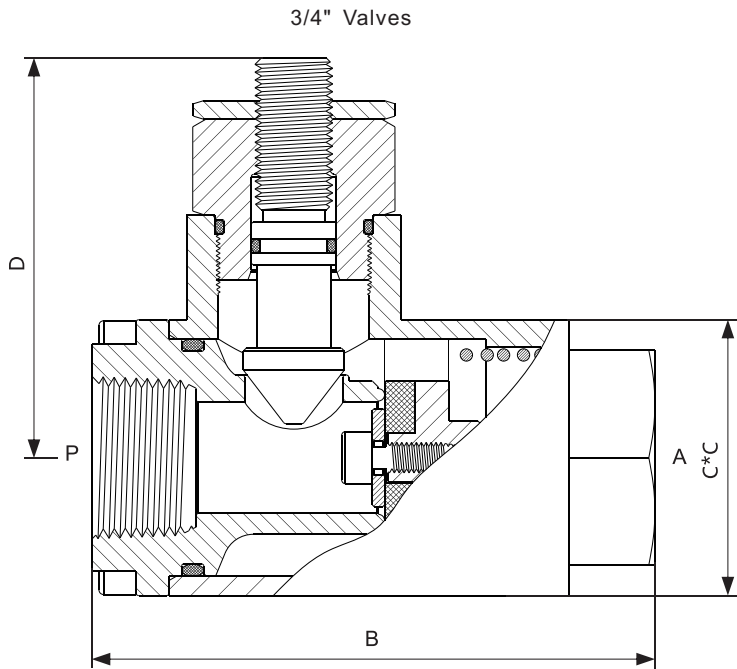

Work Pressure	MAX.200 psig(13.8 bar)	Wetted Material	316 SS & Buna N
Check Pressure	5 psig(0.3 bar)	Valve Ports	3/4 Female NPT
Work Temperature	-40~203°F(-40~95°C)standard valve		

Size B	3.61 in.(91.8 mm)	Cv Factor	5.93 (A to P) MAX.
Size C	1.7 in.(45 mm)	Cv Factor	11 (P to A)
Size D(MIN)	2.56 in.(65.1 mm)		

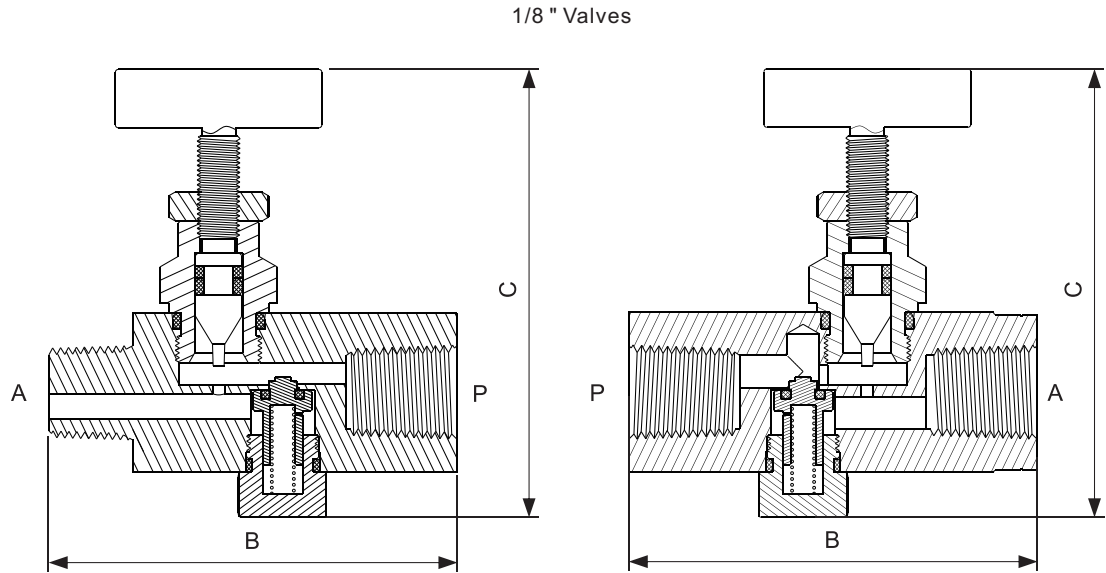

Work Pressure	MAX.1000Psig(68.9bar)	Wetted Material	316 SS & Buna N standard
Check Pressure	5 psig(0.3 bar)	Valve Ports	1/8 FNPT & 1/8 NPT
Work Temperature	-40~250°F(-23~120°C)standard	—	—

Size B	1.75 in.(44.5 mm)	Cv Factor	0.4 (P to A)
Size C	1.92 in.(48.8 mm)	Cv Factor	0.1 (A to P) MAX.

### Ordering Code:FCV-SS-FN2-M

Code	Body Material	Code	Port P	Code	Port A
SS	316SS	FN 2	1/8 Female NPT	None	Same as port P
		FN 8	1/2 Female NPT	M	Male NPT, but the same size as port P
		FN 12	3/4 Female NPT		

Other sizes and types available upon request.  
For special requirements, please contact us.

### Repair Kit

Repair kit:Contains all seals.

### Repair Kit Ordering Code : KIT-FCV-12

Code	Valve Port
2	1/8 NPT
8	1/2 NPT
12	3/4 NPT



# Volume Bottle & Accumulator



### Features

- ★ 316 stainless steel construction.
- ★ Quick response to fluid system demands.
- ★ Completely repairable.
- ★ Proven durability and performance.

### Description

Volume bottle & accumulator as a buffer element in the system. It can compensate for temperature-induced pressure changes. When the discharge pressure, it can extend the time.  
The accumulator is for hydraulic service. It is a spring return device and the initial load of the spring can be set by a bolt.

### Construction & Specifications

Accumulator for Hydraulic service  
ACL-D3SS-1A-H

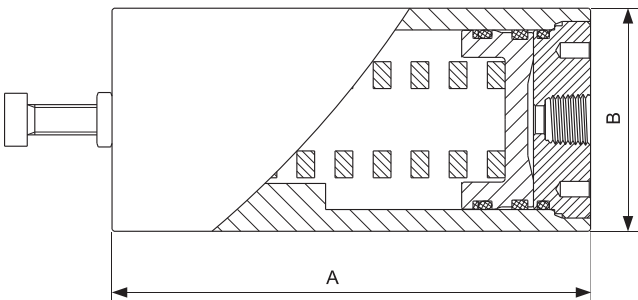

Volume bottle for pneumatic service  
DVB-D3SS-1A-P

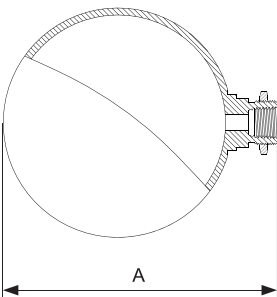

Ordering Code: ACL-D3SS-1A-H

Working Pressure	MAX.300 psig(20.7 bar)	Wetted Material	316 SS & Buna N
Spring Set Pressure	0~60 psig(0~4.1 bar)	Port	1/4 Female NPT
Work Temperature	-40~250°F(-40~120°C )standard	Volume	0.1L

Size A	5 in.(127 mm)
Size B	2.31 in.(58.7 mm)

Ordering Code for volume bottle: DVB-D3SS-1A-P

Working Pressure	MAX.300 psig(20.7 bar)	Wetted Material	316
Work Temperature	-100~1200°F(-73~639°C)	Port	1/4 Female NPT
Size A	4 in.(101.6 mm)	Volume	0.35L
Ball Diameter	4 in.(101.6 mm)	Mount Panel Hole	0.75 in.(19.1 mm)



# Vent Fill Cap & Flame Arrestor



### Features

- ★ All 316 stainless steel construction.

### Description

The Flame Arrestor provides protection for the enclosure or the tank contents in case of fire or any possible ignition source outside. Under normal conditions, the cover prevents rain, dust or other contaminants from entering the enclosure or tank.

The vent cap designed to relieve pressure due to entrapped gases in a hydraulic reservoir through a spring loaded cover. Under normal conditions, the cover prevents rain, dust or other contaminants from entering into the hydraulic reservoir.

### Construction & Specifications

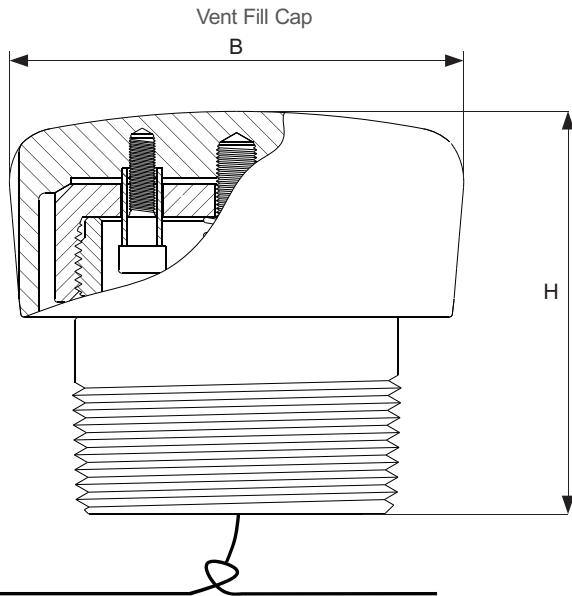
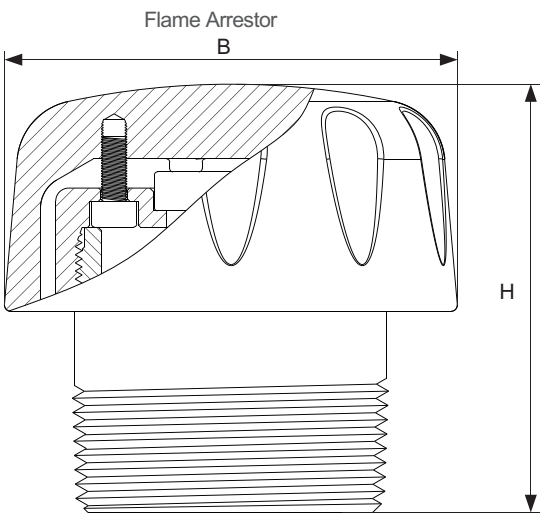

Flame Arrestor Ordering Code: VP-SS-FN24

Element Port Size	100 um	Port	1-1/2Female NPT
Size H	2.27 in.(57.7 mm)	Size B	2.68 in.(68 mm)

Vent Fill Cap Ordering Code: VF-SS-FN24

Port	1-1/2Female NPT	Size B	2.75 in.(69.8 mm)
Size H	2.6 in.(66 mm)		



# Hydraulic Regulator

## Features

- ★ 316 stainless steel construction makes the valve has good corrosion resistance.
- ★ Main valve metal to metal seal.
- ★ Maximum inlet pressure: 10000 psig(689 bar).
- ★ Six outlet pressure ranges: B(200-10000 psig)、C(50-6000 psig)、D(25-4000 psig)、E(15-2500 psig)、F(5-800 psig)、G(5-300 psig).
- ★ Working temperature:-15°F~165°F(-26°C~74°C).
- ★ Spring loaded pressure reducing regulator.
- ★ Piston-sensed design ensures safety and reliability
- ★ Downstream pressure vent(relief) port optional.
- ★ Flow coefficient : 0.12

## Description

Turning the handle clockwise will increase the spring exerted tension to increase the regulator output pressure. Rotating the handle counter-clockwise will decrease the regulator output pressure. When the downstream pressure is higher than the set pressure the downstream pressure will relief from the vent port.

## Construction & Specifications

in.(mm)

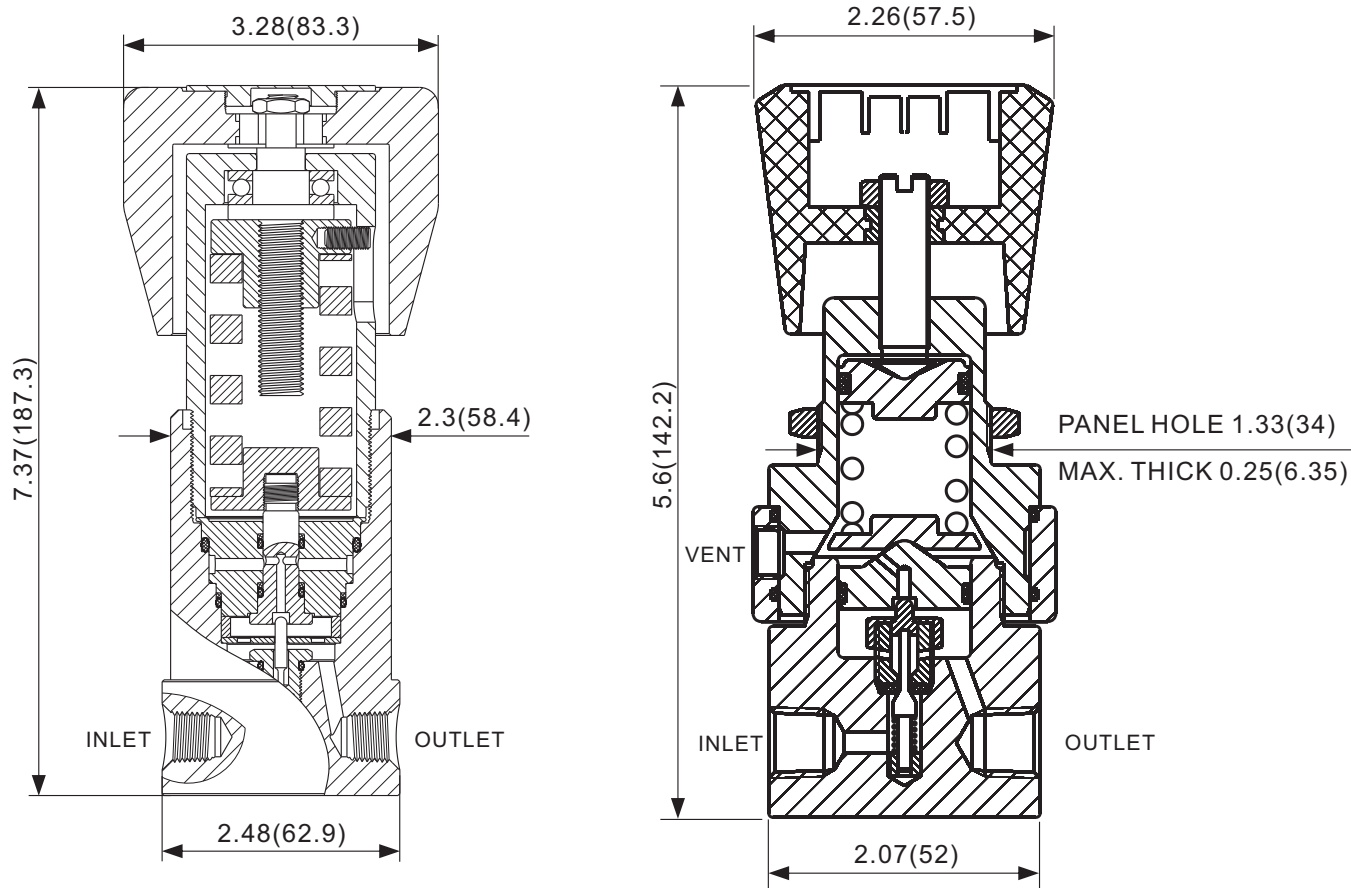

## Typical Flow Chart

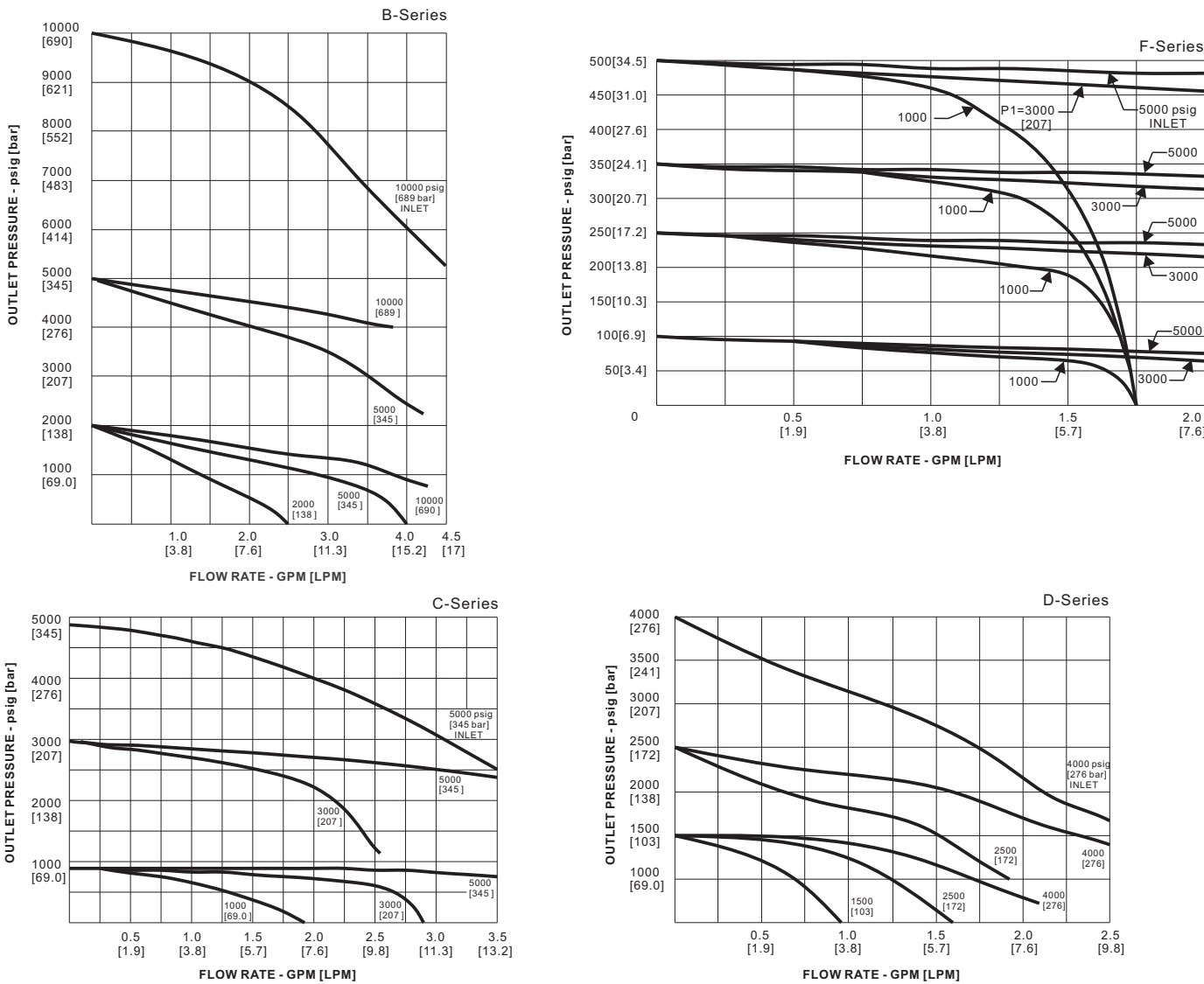

## Ordering Code : PRV-10SS-FN4-BV

<table><tr><th>Code</th><th>Inlet Pressure</th></tr><tr><td>10</td><td>MAX.10000 psi</td></tr><tr><td>06</td><td>MAX.6000 psi</td></tr></table>		Code	Inlet Pressure	10	MAX.10000 psi	06	MAX.6000 psi	<table><tr><th>Code</th><th>Connection Size</th></tr><tr><td>4</td><td>1/4"</td></tr><tr><td>6</td><td>3/8"</td></tr><tr><td>8</td><td>1/2"</td></tr></table>		Code	Connection Size	4	1/4"	6	3/8"	8	1/2"	<table><tr><th>Code</th><th>Outlet Pressure Ranges</th></tr><tr><td>B</td><td>200-10000 psig</td></tr><tr><td>C</td><td>50-6000 psig</td></tr><tr><td>D</td><td>25-4000 psig</td></tr><tr><td>E</td><td>15-2500 psig</td></tr><tr><td>F</td><td>5-800 psig</td></tr><tr><td>G</td><td>5-300 psig</td></tr></table>		Code	Outlet Pressure Ranges	B	200-10000 psig	C	50-6000 psig	D	25-4000 psig	E	15-2500 psig	F	5-800 psig	G	5-300 psig	<table><tr><th>Code</th><th>Vent(downstream)</th></tr><tr><td>V</td><td>1/4 Female NPT</td></tr><tr><td>None</td><td>Without Vent</td></tr></table>		Code	Vent(downstream)	V	1/4 Female NPT	None	Without Vent
Code	Inlet Pressure																																								
10	MAX.10000 psi																																								
06	MAX.6000 psi																																								
Code	Connection Size																																								
4	1/4"																																								
6	3/8"																																								
8	1/2"																																								
Code	Outlet Pressure Ranges																																								
B	200-10000 psig																																								
C	50-6000 psig																																								
D	25-4000 psig																																								
E	15-2500 psig																																								
F	5-800 psig																																								
G	5-300 psig																																								
Code	Vent(downstream)																																								
V	1/4 Female NPT																																								
None	Without Vent																																								
<table><tr><th>Code</th><th>Material</th></tr><tr><td>SS</td><td>316 SS</td></tr></table>		Code	Material	SS	316 SS	<table><tr><th>Code</th><th>Inlet And Outlet Port Type</th></tr><tr><td>FN</td><td>Female NPT</td></tr></table>		Code	Inlet And Outlet Port Type	FN	Female NPT																														
Code	Material																																								
SS	316 SS																																								
Code	Inlet And Outlet Port Type																																								
FN	Female NPT																																								



# High Pressure Filter



### Features

- ★ Up to 30,000 psig (2069 bar) capability.
- ★ Stainless Steel wetted materials.
- ★ Standard Buna N seals, other seals available.
- ★ 316 sintered elements, 316 stainless steel mesh elements and glass Fiber elements available.
- ★ Filter element replaceable without removing body from system.
- ★ Filters with indicator available.
- ★ Filters with drain port available.

### Specifications & Dimensions

#### 10000 psig filters

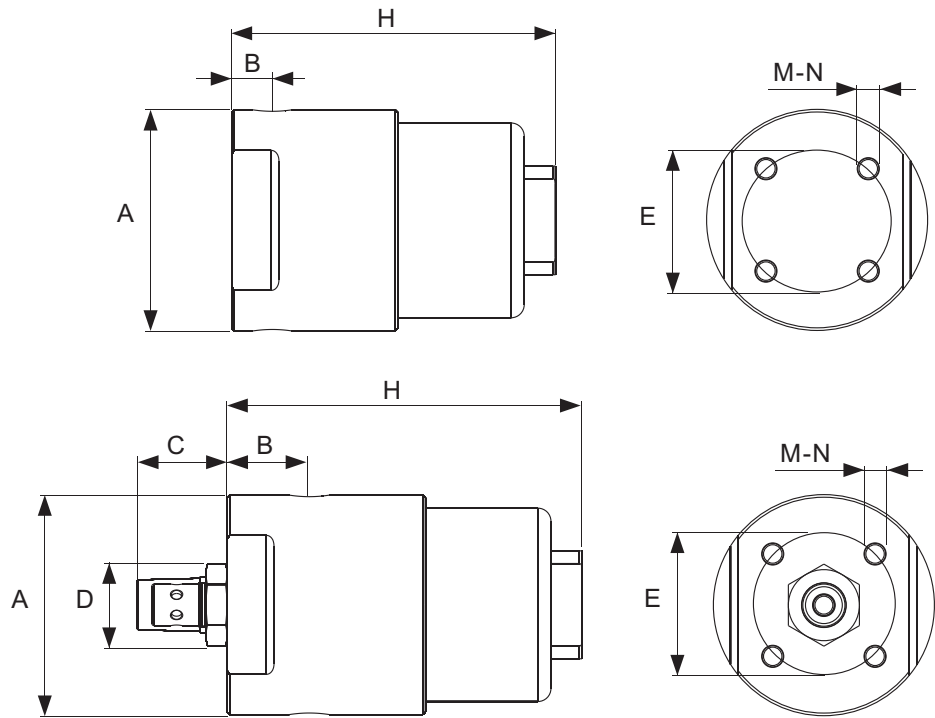

Body Material	316 SS
Max.Work Pressure(psig)	10000
Housing Rated(L/min)	5, 10, 15, 25
Micron Rating(μ)	1, 5, 7, 15, 25, 35, 50, 75, 100
Seal Material	Buna-N,
Visual Indicator Setting(Bar)	5, 10

Size	Without Indicator	With Indicator
A	3.31 in.(84 mm)	3.31 in.(84 mm)
B	0.61 in.(15.5 mm)	1.24 in.(31.5 mm)
C	-	1.35 in.(34.3 mm)
D	-	1.26 in.(32 mm)
E	2.17 in.(55 mm)	2.17 in.(55 mm)
M-N	4-M8	4-M8
H (5L/min)	3.74 in.(95 mm)	5.59 in.(142 mm)
H (10L/min)	4.84 in.(123 mm)	6.69 in.(170 mm)
H (5L/min)	5.94 in.(151 mm)	7.80 in.(198 mm)
H (10L/min)	8.27 in.(210 mm)	10.04 in.(255 mm)
Inlet/Outlet port	1/4, 3/8, 1/2 FNPT	1/4, 3/8, 1/2 FNPT

#### 20000 psig filters

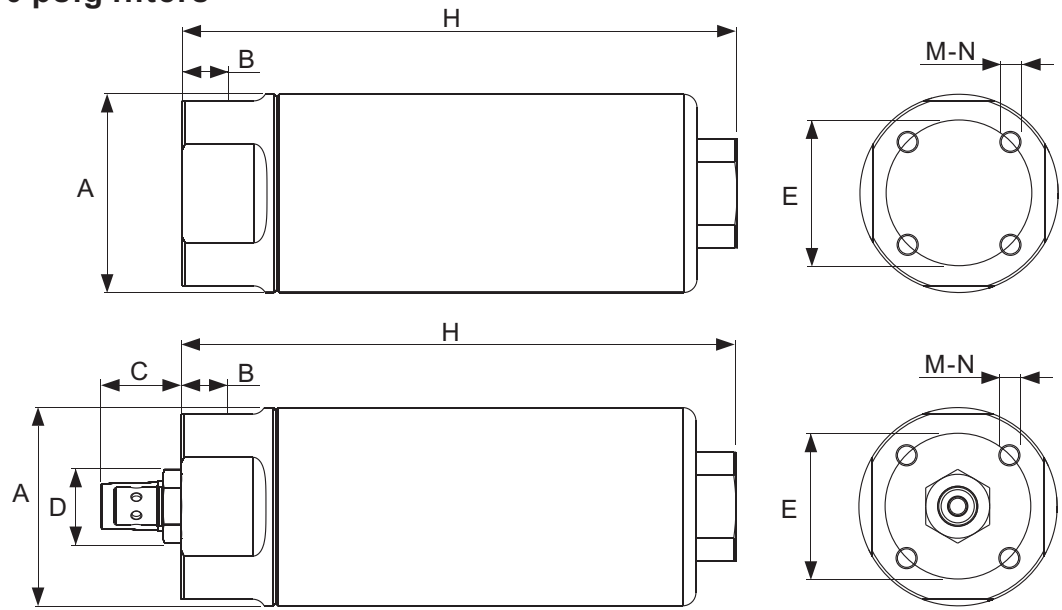

Body Material	17-4 PH	Size	Without Indicator	With Indicator
Max.Work Pressure	20000 psig	A	2.95 in.(75 mm)	2.95 in.(75 mm)
Housing Rated(L/min)	5, 10, 15, 25	B	0.75 in.(19 mm)	1.26 in.(32 mm)
Micron Rating(μ)	1, 5, 7, 15, 25, 35, 50, 75, 100	C		1.35 in.(34.3 mm)
Seal Material	Buna-N,	D		1.26 in.(32mm)
Indicator Setting	5bar, 10bar	H (5L/min)	5.67 in.(144 mm)	7.56 in.(192 mm)
Inlet/Outlet port	3/8 female medium press. connection	H (10L/min)	6.34 in.(161 mm)	8.23 in.(209 mm)
Size E	2.17 in.(75 mm)	H (15L/min)	7.01 in.(178 mm)	8.90 in.(226 mm)
Size M-N	4-M8	H (25L/min)	8.27 in.(210 mm)	10.16 in.(258 mm)

#### 30000 psig filters

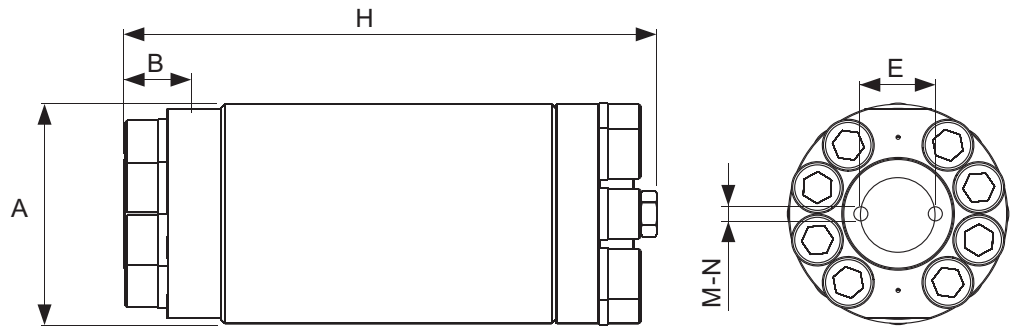



Ordering Code : HFT-10SS-25S25-VA5

Code	Max.Out Pressure	Code	House Rated	Code	Micron Rating	Code	Indicator Press.
30	30000 psig	5	5L/m house	1	1 μ	5	5Bar
20	20000 psig	10	10L/m house	5	5 μ	10	10Bar
10	10000 psig	15	15L/m house	7	7 μ		
		25	25L/m house	15	15 μ		
				25	25 μ		
				35	35 μ		
				50	50 μ		
				75	75 μ		
				100	100 μ		

Code	Housing Material	Code	Indicator
CS	Alloy steel	A	With Indicator
S4	304	None	Without
SS	316SS		
S4H	S17400		

Code	Element Code	Code	Vent
S	316 Sintered	V	With Vent
M	Stainless Mesh	None	Without
G	Glass Fiber		

Indicator not for 30000 psig filters.  
Other sizes and types available upon request. For special requirements, please contact us.

Element Ordering Code: HFT-E-25M15

Code	House Rated	Code	Element Code	Code	Micron Rating
5	5L/m house	S	316 Sintered	1	1 μ
10	10L/m house	M	Stainless Mesh	5	5 μ
15	15L/m house	G	Glass Fiber	7	7 μ
25	25L/m house			15	15 μ
				25	25 μ
				35	35 μ
				50	50 μ
				75	75 μ
				100	100 μ

Repair kit

Repair kit:Contains all seals

Repair Kit Ordering Code: KIT-HFT-10-A5

Code	Max.Out Pressure	Code	Indicator	Code	Indicator Press.
30	30000 psig	A	With Indicator	5	5Bar
20	20000 psig	None	Without	10	10Bar
10	10000 psig				



Gauge Valve

Features

- ★ 316 stainless steel construction.
- ★ Prevents galling due to the no-rotation stem.
- ★ Packing blow stem threads designed for reliable sealing.
- ★ Vee or Regulating stem for flow control and shut-off.
- ★ Working temperature ranges from -100°F to 450°F (-73°C to 232°C) for standard valves with PTFE packing. And other packing materials available, such as graphite.
- ★ Gland locking device prevent loosening of the packing gland.



Construction & Specifications

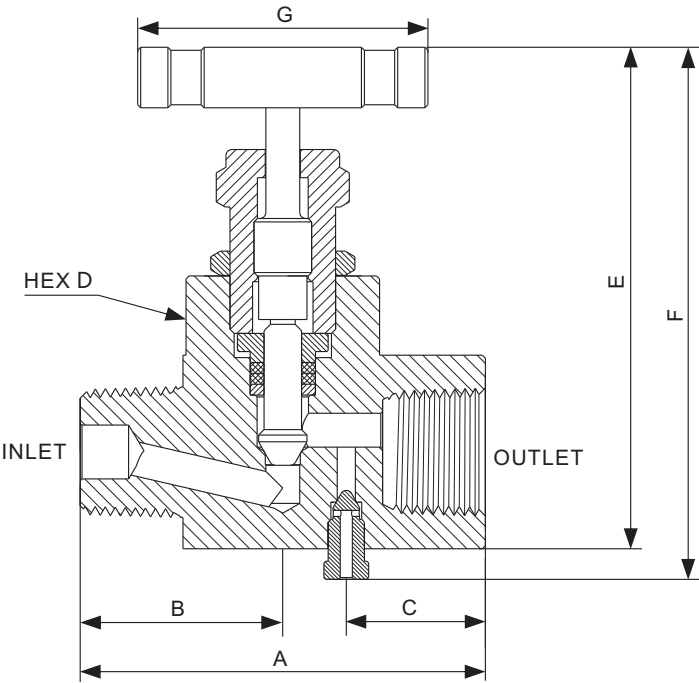

Ordering Code

Work Pressure	Size	Orifice in(mm )	Connection, Inlet to Out let	
			Female-Female	Male-Female
10000psig	1/4"	0.15(3.80)	NV-10SS-FN4-V	NV-10SS-MN4-FN4-V
	1/2"	0.22(5.60)	NV-10SS-FN8-V	NV-10SS-MN8-FN8-V

Dimensions

Ordering Code	in.(mm)						
	A	B	C	D	E	F	G
NV-10SS-FN4-V	2.20(56.00)	1.10(28.00)	0.80(20.20)	0.87(22.00)	3.04(77.30)	3.44(87.50)	2.17(55.00)
NV-10SS-FN8-V	2.64(67.00)	1.32(33.50)	0.91(23.00)	1.26(32.00)	3.26(82.90)	3.46(88.00)	2.17(55.00)
NV-10SS-MN4-FN4-V	2.20(56.00)	1.10(28.00)	0.80(20.20)	0.87(22.00)	3.04(77.30)	3.44(87.50)	2.17(55.00)
NV-10SS-MN8-FN8-V	2.64(67.00)	1.32(33.50)	0.91(23.00)	1.26(32.00)	3.26(82.90)	3.46(88.00)	2.17(55.00)

1. MN means male NPT . FN means female NPT.
2. Ordering codes listed are standard. Other sizes, materials and types are available upon request. For special requirements, please contact us.



# BB Valve & DBB Valve

### Features

- ★ 316 stainless steel Bar stock body.
- ★ combines piping & instrument valves in one body.
- ★ Weight,space and cost saving over traditional designs.
- ★ Standard high performance bonnet design.
- ★ Blowout-proof valve stems and needles.
- ★ Working temperature ranges from -100°F to 450°F (-73°C to 232°C) for standard valves with PTFE packing. And other packing materials available, such as graphite.

### Description

The BB valves are block and bleed valves. The DBB valves are double block and bleed valves.The opening and closing of these valves is accomplished by needle valves. They mainly used to connect pressure gauges and other instruments.

### Construction & Specifications

#### BB Valves

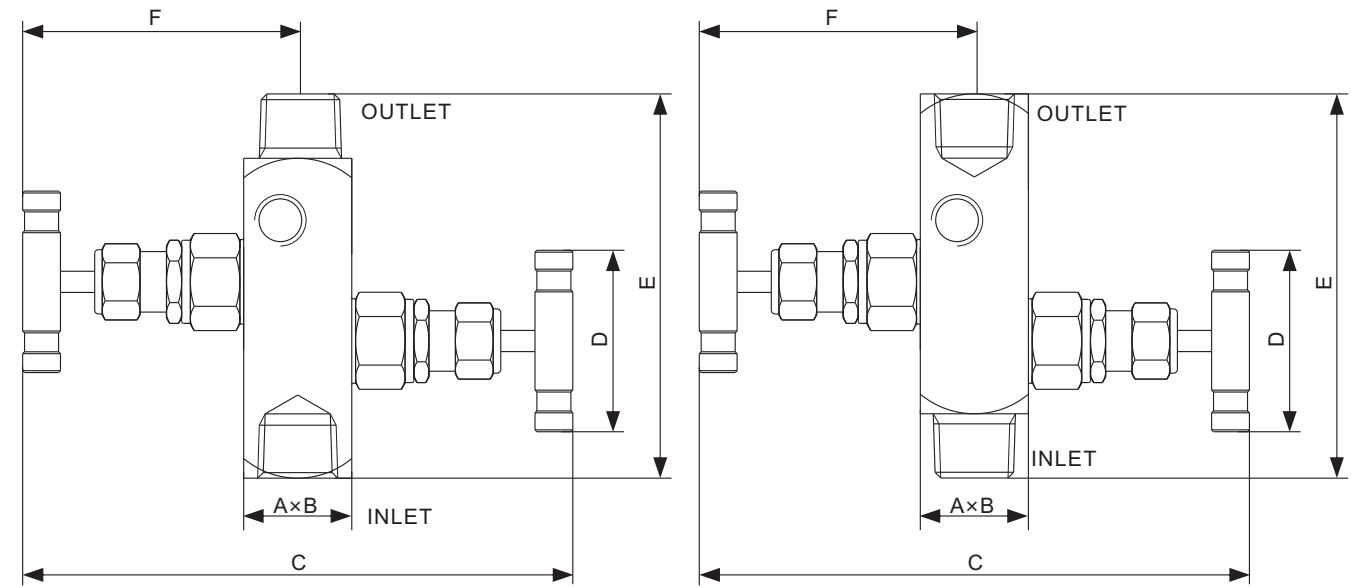

Work Press.	Size	Orifice in( mm)	Vent/Bleed	Connection, Inlet to Out let	
				1/2 Female -1/2 Male NPT	1/2 Male-1/2 Female NPT
10000psig	1/2"	0.22(5.60)	1/4 Female NPT	BBV-10SS-FN8-MN8	BBV-10SS-MN8-FN8

in.(mm)									
Ordering Code	A	B	C open	C close	D	E	F open	F close	
BBV-10SS-FN8-MN8-V	1.56(39.60)	1.75(44.50)	6.22(158.00)	5.98(152.00)	2.17(55.00)	4.00(102.00)	3.64(92.50)	3.52(86.50)	
BBV-10SS-MN8-FN8-V	1.56(39.60)	1.75(44.50)	6.22(158.00)	5.98(152.00)	2.17(55.00)	4.00(102.00)	3.64(92.50)	3.52(86.50)	

1. MN means male NPT . FN means female NPT.
2. Ordering codes listed are standard. Other sizes, materials and types are available upon request. For special requirements, please contact us.

#### DBB Valves

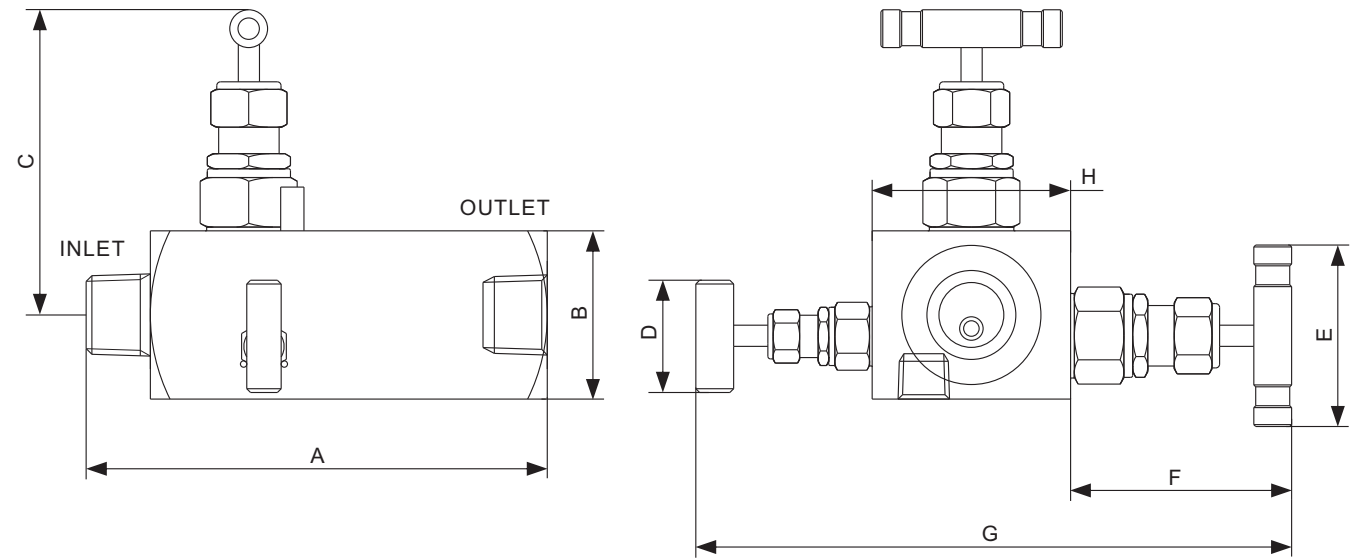

### Ordering Code

Work Press.	Size	Orifice in( mm)	Vent/Bleed	Connection, Inlet to Out let	
				1/2 Female -1/2 Female	1/2 Male-1/2 Female
10000psig	1/2"	0.22(5.60)	1/4 Female NPT	DBB-10SS-FN8	DBB-10SS-MN8-FN8

### Dimensions

in.(mm)									
Ordering Code	A	B	C	D	E	F open	G open	H	
DBB-10SS-FN8-MN8	4(101.6)	1.56(39.60)	4.33(110.00)	1.25(31.80)	2.17(55.00)	3.64(92.50)	6.22(158.00)	1.75(44.50)	
DBB-10SS-MN8-FN8	4(101.6)	1.56(39.60)	4.33(110.00)	1.25(31.80)	2.17(55.00)	3.64(92.50)	6.22(158.00)	1.75(44.50)	

1. MN means male NPT . FN means female NPT.
2. Ordering codes listed are standard. Other sizes, materials and types are available upon request. For special requirements, please contact us.



# Relief Valve

## Features

- ★ 316 stainless steel construction makes the valve has good corrosion resistance.
- ★ Set pressure:50~15000 psig (3.5~1035 bar).
- ★ Working temperature:-22°F~250°F(-30°C~120°C).
- ★ Spring loaded relief valve.
- ★ Piston-sensed design ensures safety and reliability
- ★ Longer life due to metal to metal sealing .

## Description

When the system pressure is higher than the set pressure, the relief valve spool will crack and the valve will exhaust until the system pressure is lower than the set pressure and the valve will reseal.

Turning the Spring housing clockwise will increase the relief valve pressure setting.

Rotating the Spring housing counterclockwise will decrease the relief valve pressure setting. Once the exact pressure relief setting required is achieved, the lock nut should be tightened against the spring housing to maintain the appropriate setting.

## Construction & Specifications

### 15 Series

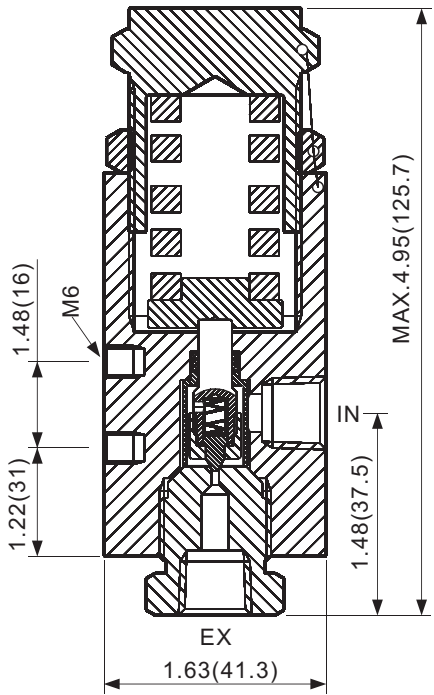

Ordering Code	Set press. range	MAX. Flow	Port
RV-15SS-FN4-D	751-1500 psig	3.2L/min water	1/4Female NPT
RV-15SS-FN4-E	1501-3000 psig	3.6L/min water	1/4Female NPT
RV-15SS-FN4-F	3001-6000 psig	4.4L/min water	1/4Female NPT
RV-15SS-FN4-G	6001-10000 psig	5.2L/min water	1/4Female NPT
RV-15SS-FN4-H	10000-15000 psig	6.1L/min water	1/4Female NPT

Ordering codes listed are standard. Other sizes, materials and types are available upon request. For special requirements, please contact us.

### 06 Series

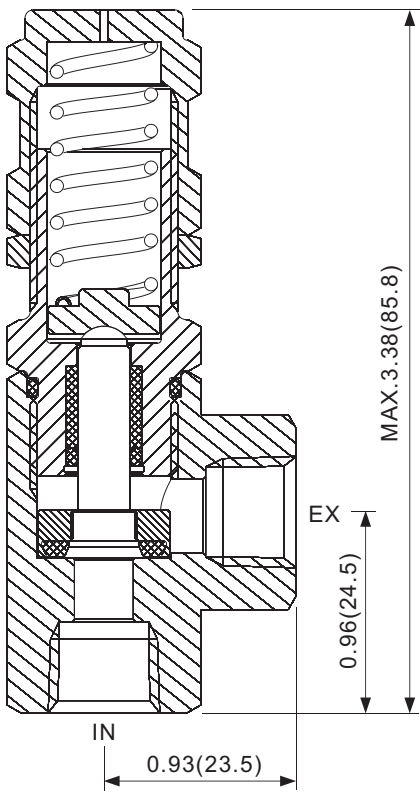

Ordering Code	Set press. range	MAX. Flow	Port
RV-06SS-FN4-A	50-150 psig	5.9L/min water	1/4Female NPT
RV-06SS-FN4-B	151-350 psig	5.6L/min water	1/4Female NPT
RV-06SS-FN4-C	351-750 psig	5.7L/min water	1/4Female NPT
RV-06SS-FN4-D	751-1500 psig	5.7L/min water	1/4Female NPT
RV-06SS-FN4-E	1501-3000 psig	6.1L/min water	1/4Female NPT
RV-06SS-FN4-F	3001-6000 psig	6.1L/min water	1/4Female NPT

Ordering codes listed are standard. Other sizes, materials and types are available upon request. For special requirements, please contact us.